

Application for tree works: works to trees subject to a tree preservation order (TPO) and/or notification of proposed works to trees in a conservation area.
Town and Country Planning Act 1990

Publication of applications on planning authority websites.

Please note that the information provided on this application form and in supporting documents may be published on the Authority's website.
If you require any further clarification, please contact the Authority's planning department.

1. Applicant Name, Address and Contact Details

Title:	Mr	First name:	David	Surname:	Small
Company name:					
Street address:	The Glebe House			Country Code	National Number
	Church Lane			44	
	Orleton			Telephone number:	
Town/City:	Ludlow			Mobile number:	
County:				Fax number:	
Country:	United Kingdom			Email address:	
Postcode:	SY8 4HU				

Are you an agent acting on behalf of the applicant? ☐ Yes ☒ No

2. Agent Name, Address and Contact Details

No Agent details were submitted for this application

3. Trees Location

Please provide the address of the site where the tree(s) stands (full address if possible):

House:		Suffix:	
House name:	The Glebe House		
Street address:	Church Lane		
Town/City:	Orleton		
County:	Herefordshire		
Postcode:	SY8 4HU		

Description:

If the location is unclear or there is not a full postal address, either describe as clearly as possible where it is (for example, 'Land to rear of 12 to 18 High Street' or 'Woodland adjoining Elm Road') or provide an Ordnance Survey grid reference:

4. Trees Ownership

The applicant is the owner of the trees

5. What Are You Applying For?

Are you seeking consent for works to a tree(s) subject to a TPO?

☐ Yes ☒ No

Are you wishing to carry out works to tree(s) in a conservation area?

☒ Yes ☐ No

6. Tree Preservation Order Details

If you know which TPO protects the tree(s) enter its title or number below

7. Identification Of Tree(s) And Description Of Works

Please identify the tree(s) and provide a full and clear specification of the works you want to carry out. Continue on a separate sheet if necessary. You might find it useful to contact an arborist (tree surgeon) for help with defining appropriate work. Where trees are protected by a TPO, please number them as shown in the First Schedule to the TPO where this is available. Use the same numbers on your sketch plan (see guidance notes).

Please provide the following information below: tree species (and the number used on the sketch plan) and description of works. Where trees are protected by a TPO you must also provide reasons for the work and, where trees are being felled, please give your proposals for planting replacement trees (including quantity, species, position and size) or reasons for not wanting to replant.

E.g. Oak (T3) - fell because of excessive shading and low amenity value. Replant with 1 standard ash in the same place.

Thuja Plicata Zebrina - front garden - fell because tree has grown to be too bulky for the garden. It is now about 10m tall and 6m diameter at ground level (max height expected to be c15m). Replant with at least three native species, details to be decided, but probably sorbus commixta, betula jacquemontii and pinus sylvestris.

8. Trees - Additional Information

For all trees

A sketch plan clearly showing the position of trees listed in Question 7 must be provided when applying for works to trees covered by a TPO. A sketch plan is also advised when notifying the LPA of works to trees in a conservation area (see guidance notes). It would also be helpful if you provided details of any advice given on site by an LPA officer.

For works to trees covered by a TPO

Please indicate whether the reasons for carrying out the proposed works include any of the following. If so, your application must be accompanied by the necessary evidence to support your proposals. (See guidance notes for further details)

1. Condition of the tree(s) - e.g. it is diseased or you have fears that it might break or fall:

If YES, you are required to provide written arboricultural advice or other diagnostic information from an appropriate expert.

☐ Yes ☒ No

2. Alleged damage to property - e.g. subsidence or damage to drains or drives.

If YES, you are required to provide for:

☐ Yes ☒ No

Subsidence

A report by an engineer or surveyor, to include a description of damage, vegetation, monitoring data, soil, roots and repair proposals. Also a report from an arboriculturist to support the tree work proposals.

Other structural damage (e.g. drains, walls and hard surfaces)

Written technical evidence from an appropriate expert, including description of damage and possible solutions.

Documents and plans (for any tree)

Are you providing additional information in support of your application?

☐ Yes ☒ No

9. Authority Employee/Member

With respect to the Authority, I am:

- (a) a member of staff
- (b) an elected member
- (c) related to a member of staff
- (d) related to an elected member

Do any of these statements apply to you?

☐ Yes ☒ No

10. Trees - Declaration

I/we hereby apply for planning permission/consent as described in this form and the accompanying plans/drawings and additional information. I/we confirm that, to the best of my/our knowledge, any facts stated are true and accurate and any opinions given are the genuine opinions of the person(s) giving them.



Date: 12/03/2015

THE GLEBE HOUSE, CHURCH LANE, ORLETON
LUDLOW SY8 4HU
SKETCH OF FRONT GARDEN

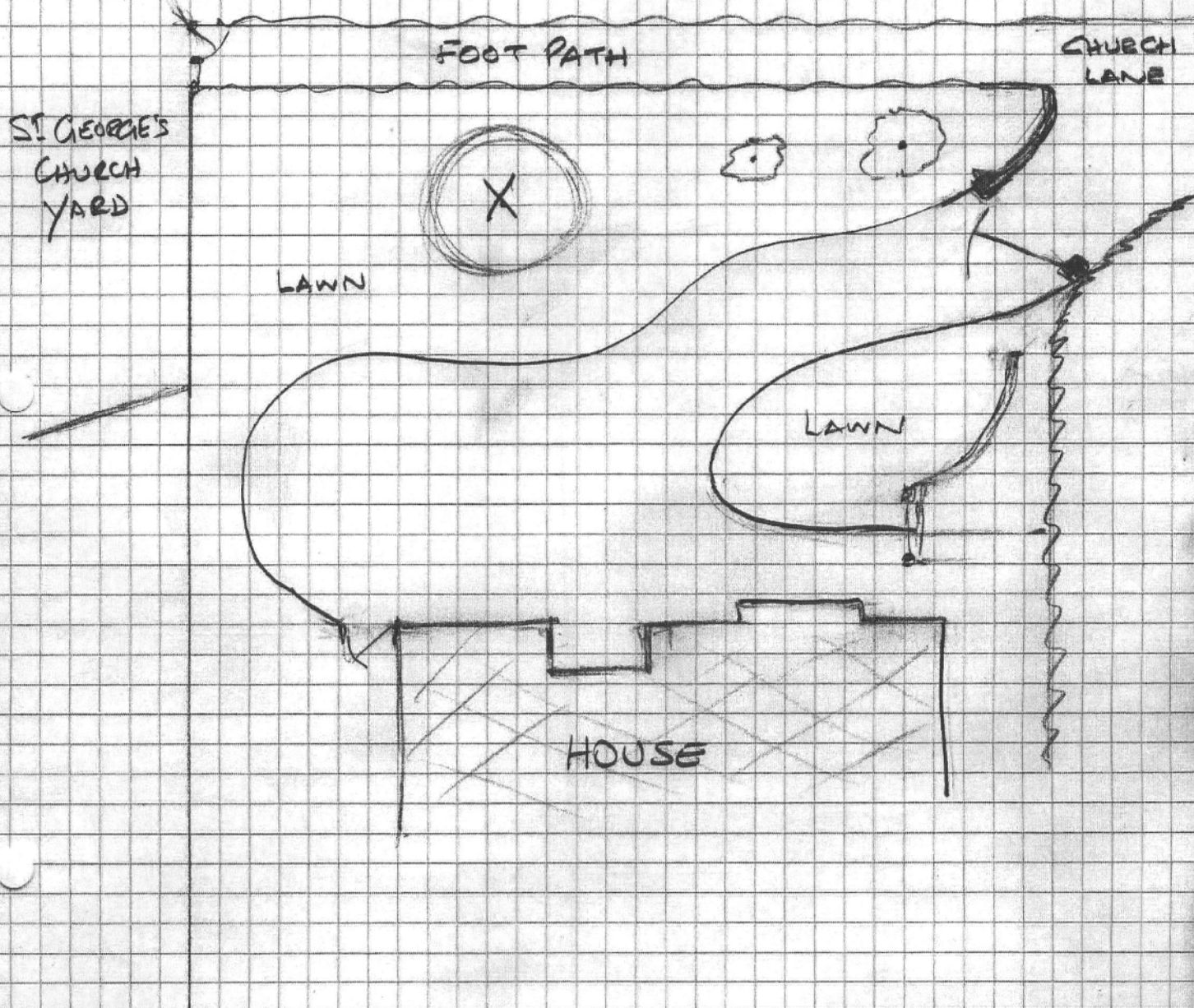

X = TREES TO BE FELLED
(THUJA PLICATA ZEBRINA)

HEREFORDSHIRE COUNCIL
PLANNING SERVICES
DEVELOPMENT CONTROL

12 MAR 2015

To:
At: File: