

The Old Forge

ables

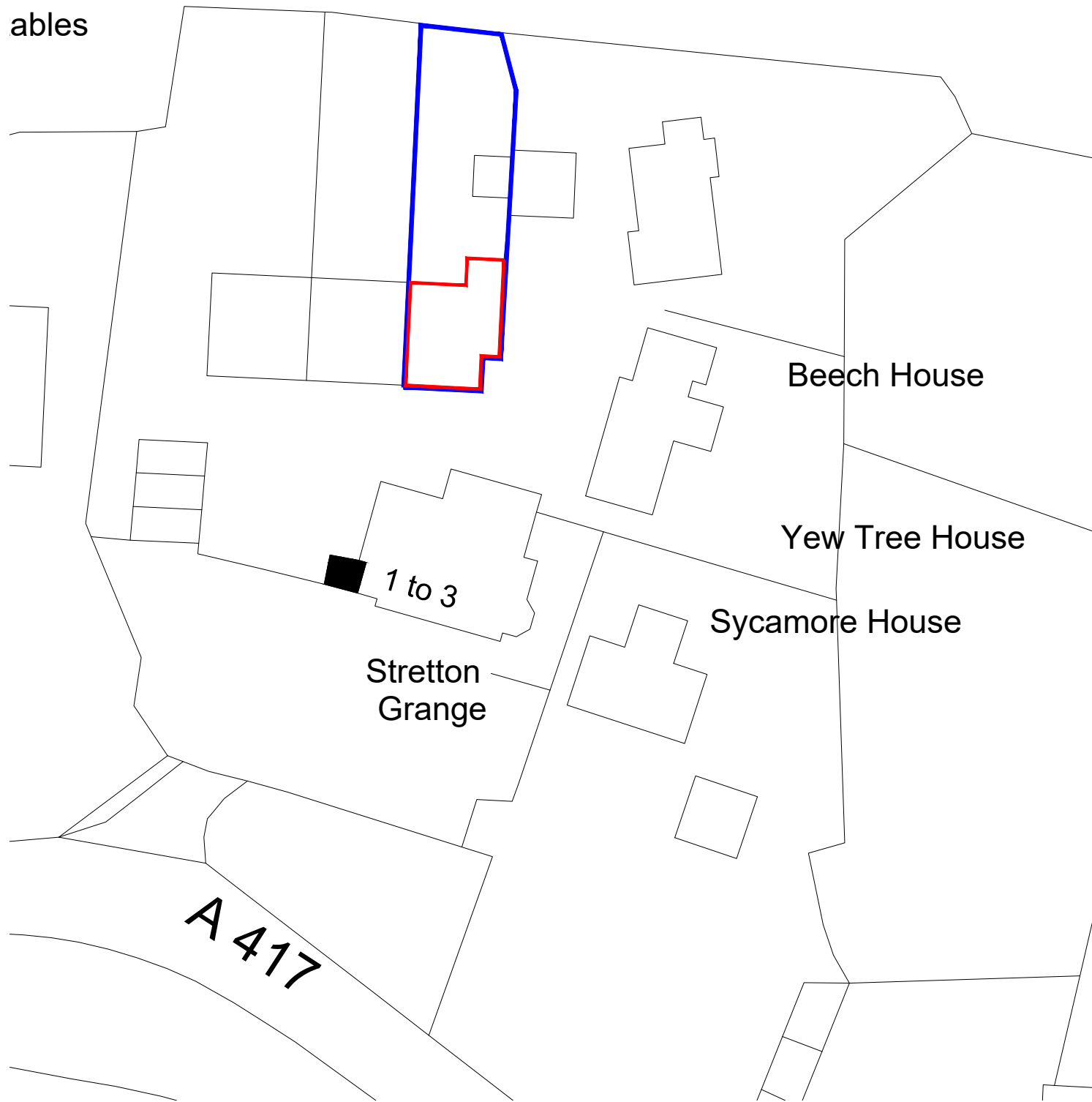

Block Plan:
1:500

The contractor is responsible to ensure that no products are to be utilised that do not comply with relevant British and/or European Standards and/or Codes of Practice, COSHH Regulations, Construction Regulations, or which are known or suspected at the time of product selection and/or construction to be deleterious to health and safety or to the durability of the work or not in accordance with good building practices.

The contractor is responsible for checking dimensions, tolerances, levels and references. This drawing/model is to be read in conjunction with all relevant Other Project Team Members' or specialists' drawings/models/any Federated Model. Any discrepancy is to be notified to Baily Garner LLP and is to be rectified before proceeding with the works on site or shop drawings. Where an item is covered by drawings to different scales, the larger scale drawing is to be worked to.

Any rights (including copyright) in this drawing/model and any proprietary work contained therein belong to Baily Garner LLP and may only be used in accordance with the licence granted to the Employer and with attribution to Baily Garner LLP.

The drawing to be read in conjunction with: Document Suitability Codes page or at www.bailygarner.co.uk/disclaimer/

A3

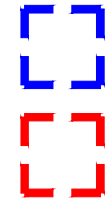

PROPERTY BOUNDARY
APPLICATION BOUNDARY

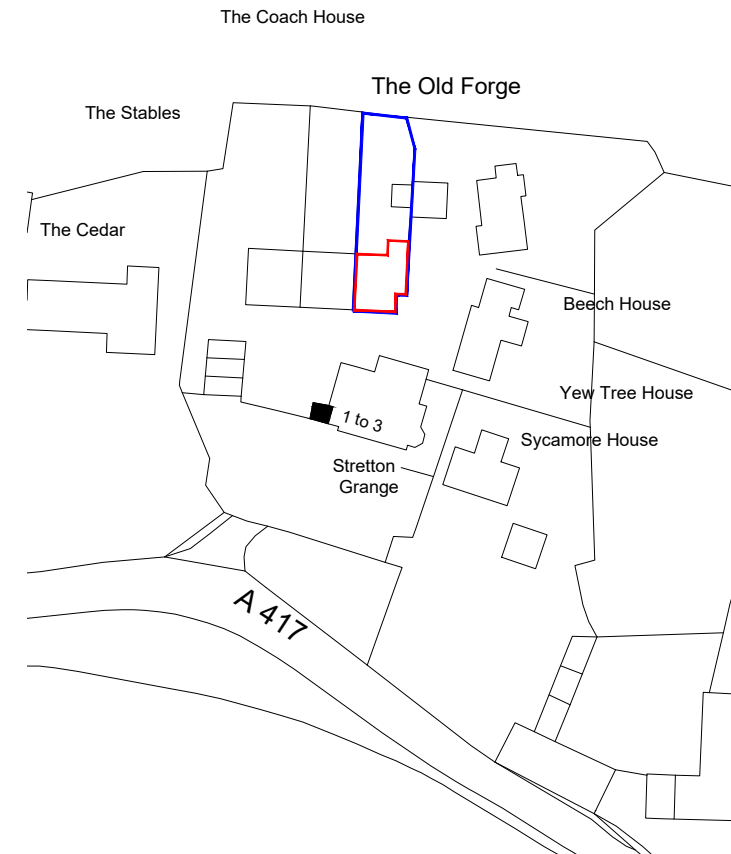

Site Location Plan:
1:1250

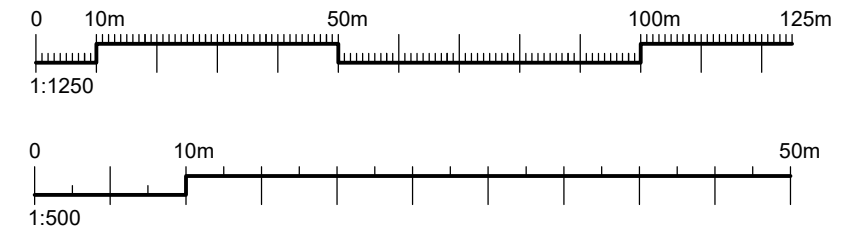

Site Location and Block Plan

HUG2 Architectural Services - The Old Forge

CLIENT NAME Herefordshire Council				PROJECT NAME HUG2 Architectural Services			
PROJECT ADDRESS The Old Forge, Hereford HR8 2TS				DRAWING TITLE Site Location and Block Plan SUITABILITY CODE S0			
SCALE: 1:500	DRAWN EB	CHECKED JM	APPROVED Approver	DATE 14/02/2024			
PROJECT NO 35402	AUTHOR BGL	VOLUME TOF	LEVEL 00	DRAWING DR	ROLE A	DRAWING 4100	REV NO 01



55 CHARLOTTE STREET
BIRMINGHAM B3 1PX
t. 0121 236 2236
e. birmingham@bailygarner.co.uk