

239425N
351959E

351979E

352000E

352020E

239425N
352020E

notes
this drawing is copyright | do not scale off this drawing |
dimensions to be checked on site | any discrepancies to
be reported to the architect immediately

this information has been based on drawings prepared by
Grantham Coates Surveys Ltd ref: GCS-OHA-0569-1 dated:
31.10.19

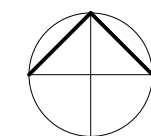

- N O T E S
- Parking and Turning: Existing hard surfacing to remain unaffected by the proposed scheme
 - Grassed Areas: Existing grass areas to remain unaffected by the proposed scheme
 - Trees: We are only proposing to remove two trees along the eastern boundary, with all other trees and their root protection areas to remain unaffected by the proposed scheme. Refer to Focus Ecology report for details
 - Boundaries: All boundary treatment to remain unaffected by the proposed scheme
 - Neighbours: Given the close proximity of 114, there are no windows along this boundary at first floor level, to maintain privacy for the residents of 114

239400N

239400N

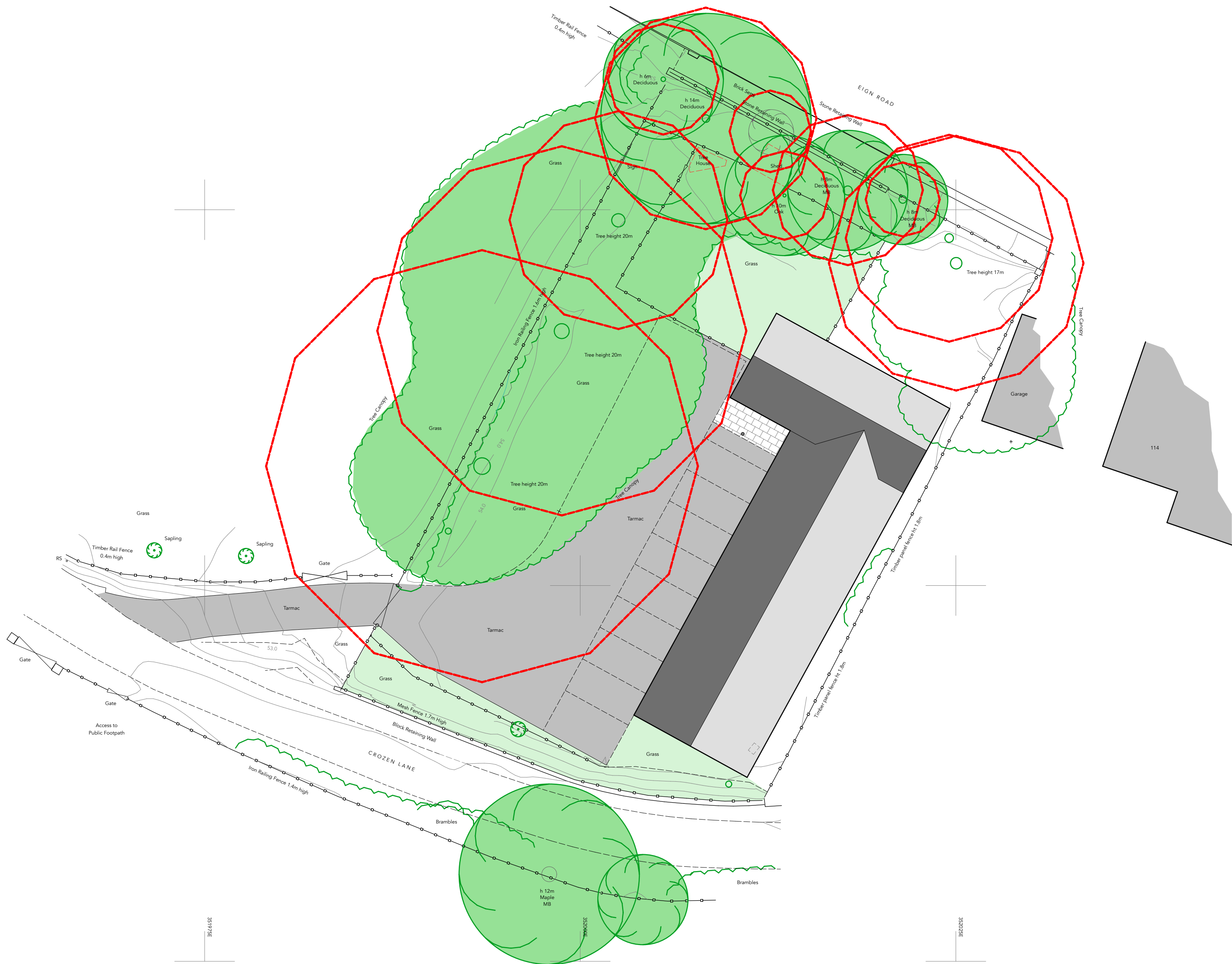

C	09.09.20	layout updated	MO
B	29.07.20	layout updated	MO
A	01.07.20	layout updated following tree report	MO
rev	date	description	int'l

OHA
OWEN HICKS ARCHITECTURE

Second Floor Offices | 46 Bridge St | Hereford | HR4 9DG
T 01432 261152
info@oha-architecture.co.uk
www.oha-architecture.co.uk

client
SOUTH MARCHES DISTRICT SCOUT COUNCIL

project
PROPOSED DEVELOPMENT
SCOUTS CORNER
CROZEN LANE
HEREFORD

drawing
AS PROPOSED
SITE PLAN

scale
1:200@A2

date
JUNE 2020

drawn
MO

project nos.
2019.059 / 7.03

status
PLANNING

drawing nos.

revision

P 004

C

351959E
239350N

351979E

352000E

352020E

239350N