

© This drawing, its contents, and all information contained therein is protected by copyright. It may be used once only for its intended purpose under a contract with John Williams DESIGN, but specifically not for any other use or purpose. This drawing is for Planning purposes and does not constitute a construction issue drawing. All setting out dimensions and levels are indicative and are subject to detailed site survey and site conditions. The Client and their agent are responsible for ensuring that Building Control and construction drawings are carried out. Do not scale from this drawing. All dimensions are to be checked on site

Application site outlined in red,  
other land in the ownership of the  
applicant outlined in blue.

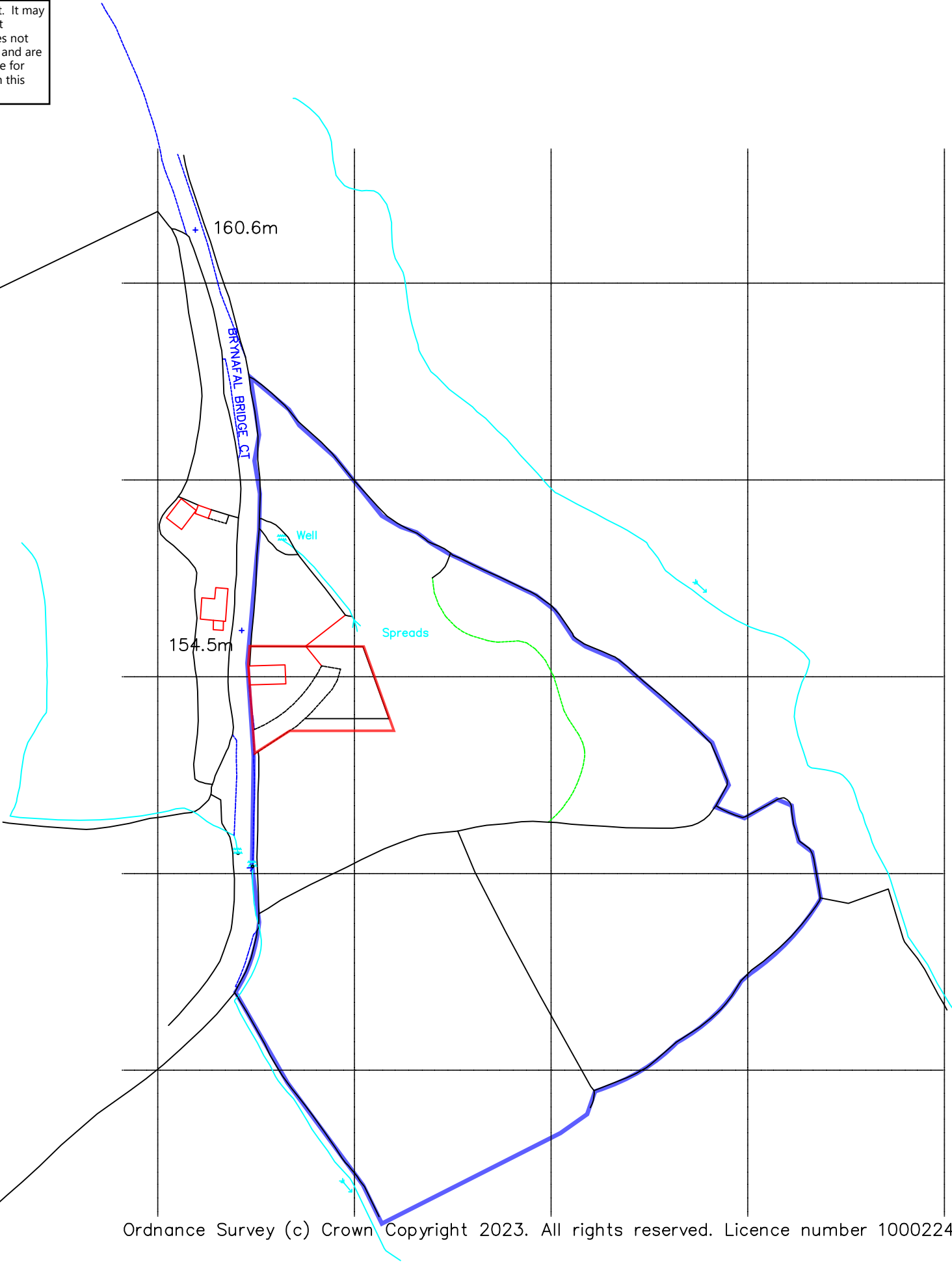
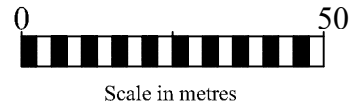

RevA (21.11.'23): Amend red line curtilage to include  
area of proposed solar panels

|                         |  |  |   |  |                                     |                   |                       |          |
|-------------------------|--|--|---|--|-------------------------------------|-------------------|-----------------------|----------|
| John Williams<br>DESIGN | John Williams DESIGN<br>ABBOTS LODGE, LEOMINSTER,<br>HEREFORDSHIRE, HR69UD<br>Tel: 07989 975295 E: john@ajmwdesign.co.uk | CLIENT/PROJECT<br>Conversion of barn known as<br>Brynafal to new 3 bedroom<br>dwelling for Laurie Vincent and<br>Kiya Corrales | SITE ADDRESS<br>Brynafal, Rhydspence,<br>Herefordshire, HR3 6ET |  | DRAWING TITLE<br>Site Location Plan | DATE<br>1.11.2023 | SCALE<br>1:1250 @A3   |          |
|                         |  |  |   |  |                                     |                   | DRG. NO<br>P 1 (4/23) | REV<br>A |