



Notes

This survey should only be relied upon for its original purpose. Grantham Coates Surveys Limited accepts no responsibility for use of this plan outside of the original remit, or by use of any party other than the original client.

Whilst every effort has been made to identify all above ground details, it should be noted that some items may have been obscured at time of survey.

Below ground drainage information has been visually inspected from the surface and should therefore be treated as approximate only.

All dimensions to be checked on site prior to design and construction.

Elevation Layout

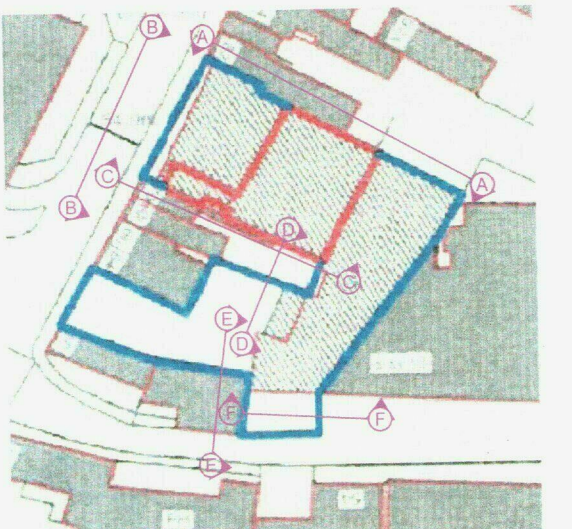

Drawing Schedule

GCS-RRR-010518-1	Ground Floor Floor Plans
GCS-RRR-010518-2	First Floor Floor Plans
GCS-RRR-010518-3	Second Floor Floor Plans
GCS-RRR-010518-4	Building Elevations & Sections

Legend

BH 1.99	Beam height
DH 1.80	Door head height
F-C 0.99	Floor to ceiling height
C-M 1.00	Ceil to head height
(99)	Structural Ceiling height
(1.96)	False Ceiling height
315.56 +	Floor level
DP	Down Pipe
VP	Soil / vent pipe
UBL 316.55	Under beam level
CL 250.00	Cill level
HL 250.00	Head level
SPR 2.50	Springer level
APX 2.50	Apex level

Grid and Datum

Grid: **OS National Grid** Datum: **Ordnance Datum Newlyn**
Survey related to Ordnance Survey National Grid (OSGB36) via GPS and the OS Active Network.
A National Grid (OSGB36) coordinate has been established on site via Transformation OSTN15 and Geoid Model OSGM15, a further OS coordinate was used to orientate the survey to Ordnance Grid.
No scale factor has been applied to the survey

Title: **SURVEY OF LAND AT
72-80 Widemarsh Street
Hereford
(Building Elevations & Sections)**

Client: **RRA Architects
Watershed
Wye Street
Hereford
HR2 7RB**



Land - Engineering - Building Surveyors

2 Arden Court, Arden Road, Alcester,
Warwickshire, B49 6HN

Tel: 01789 764420

E-Mail: info@gcsurveys.co.uk
Web Site: www.gcsurveys.co.uk

Drawing No:	GCS/RRR/010518/4	Rev:	-
Date:		Name:	
Drawn:	Checked:	Scale:	Date:
JMG	CC	1:100	05/07/18
File Name:	Sheet size:	Sheet:	
GCS-RRR-010518-4.dwg	A1	2 of 2	

