

## Appendix A – Site Plans and Annotated Site Plan

**Scale 1:1250**

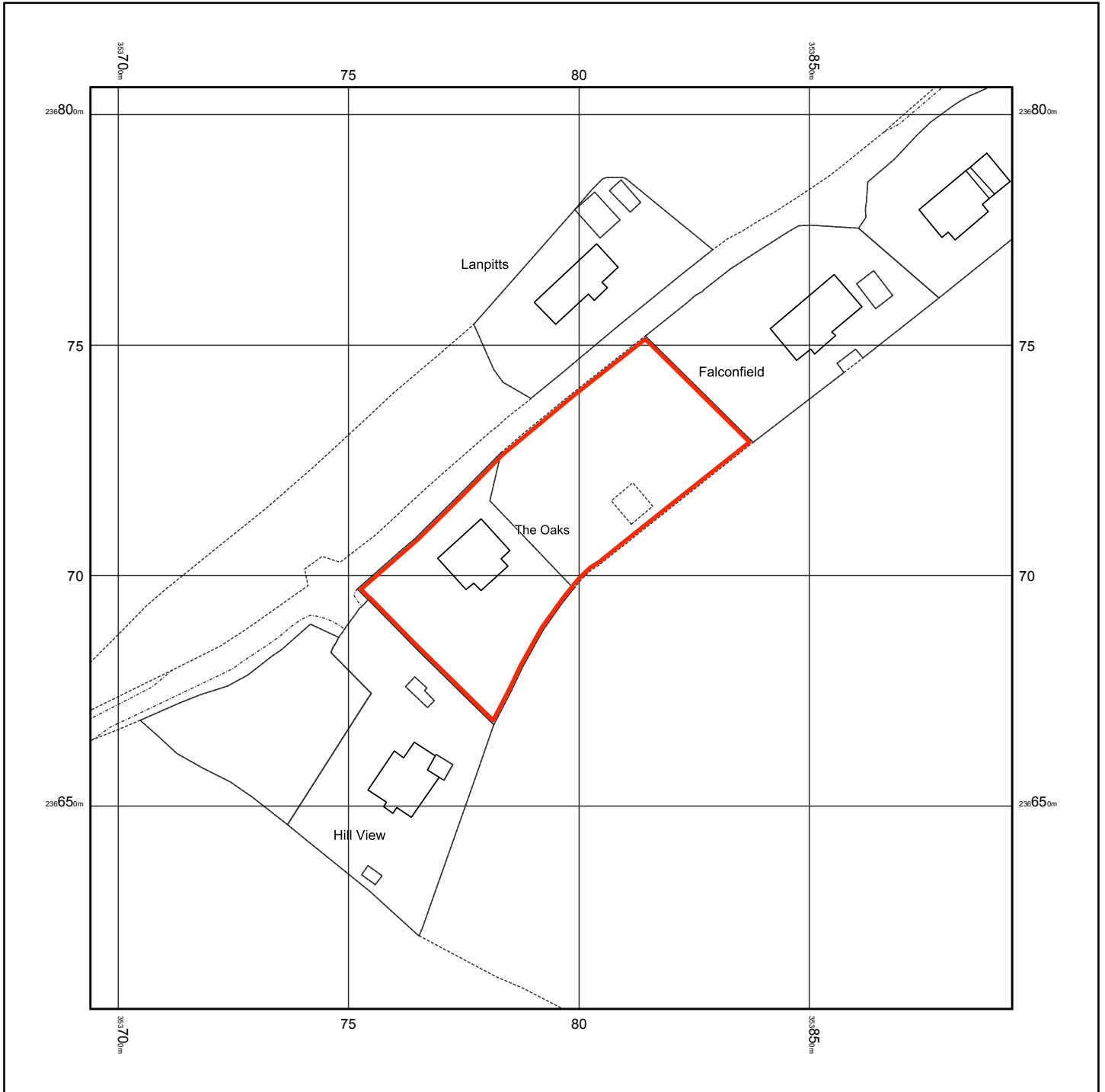

© Crown copyright and database rights 2017 Ordnance Survey 100048957. The representation of road, track or path is no evidence of a boundary or right of way. The representation of features as lines is no evidence of a property boundary.

Supplied by: [www.ukmapcentre.com](http://www.ukmapcentre.com)  
Serial No: 109129  
Centre Coordinates: 353794, 236706  
Production Date: 14/02/2017 10:42:05

**The Oaks**

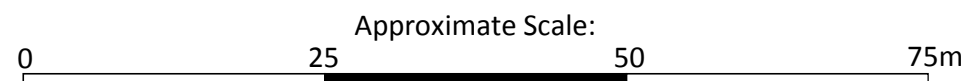

**ENVIRONMENTAL  
MANAGEMENT SOLUTIONS**

Project Number:

EMS7090a

Site:

Land at The Oaks, Church Road, Dinedor, Hereford, HR2 6LQ

Drawing Title:

Annotated Site Plan



Proposed development comprises 1 x 2 bed, 2 x 3 bed, 2 x 4 bed houses

- Plot 1 - 4 bed - 160m<sup>2</sup> plus double garage
- Plot 2 - 3 bed - 135m<sup>2</sup> plus single garage
- Plot 3 - 2 bed - 105m<sup>2</sup> plus 2no parking spaces
- Plot 4 - 3 bed - 135m<sup>2</sup> plus single garage
- Plot 5 - 4 bed - 160m<sup>2</sup> plus double garage

Site area is 0.28 hectares.  
Site density is 15 dwellings per hectare

PTP - package treatment plant  
Existing tree positions are approximate

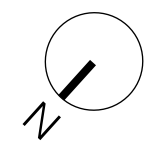

Layout based on OS Digital Data and subject to site survey.  
Serial number: 106063.  
© Crown Copyright and database right 2016.  
Ordnance Survey licence 100048957. Reproduction in whole or in part is prohibited without the prior permission of Ordnance Survey.

	<b>Proposed replacement dwelling and brownfield redevelopment at The Oaks, Church Road, Dinedor, Hereford HR2 6LQ</b>	<p>■ This is not a complete working drawing; for Planning and Building Regulations use only. Additional information may be required as work proceeds. Do not scale.</p> <p>■ This is a drawing based on third party data and as such is subject to site survey.</p> <p>■ Services and ground investigation reports were not available at the date of issue.</p> <p>This drawing is only for use with the named site. Copyright © 2017. Original sheet size A3.</p>	January 2017 Scale 1:500@A3
	<b>Indicative Site Layout</b>	<p><input type="checkbox"/> Preliminary</p> <p><input checked="" type="checkbox"/> First Issue</p> <p><input type="checkbox"/> Revision</p>	
T J Ford, MCIAT • Chartered Architectural Technologist • Building Design Consultant 30 Grove Road, Hereford, HR1 2QP • Tel 01432 340107 • mail@axysdesign.co.uk			<b>Drawing No 809-01</b>