

Ground Floor Plan

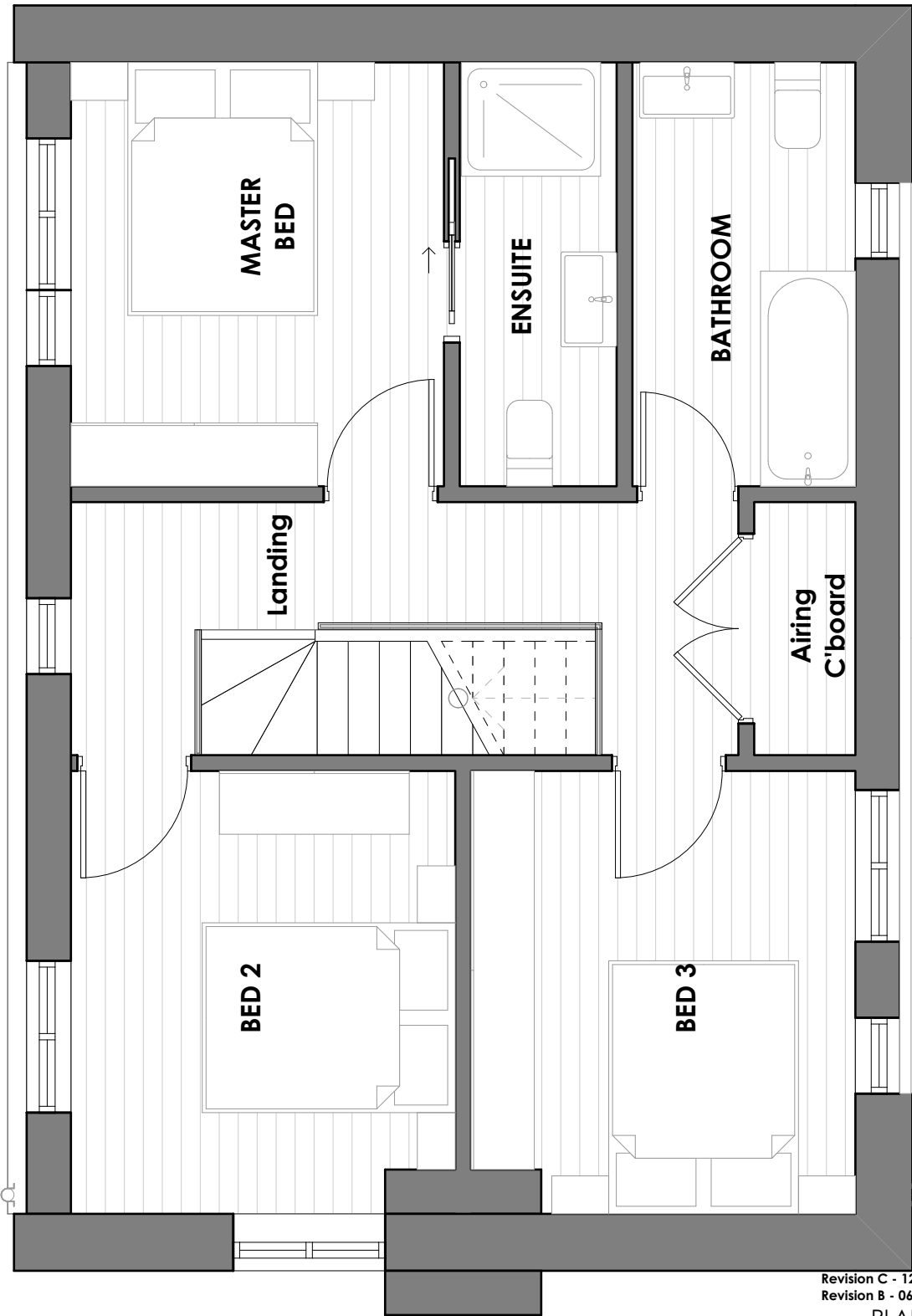

First Floor Plan

Schedule of Accommodation	
3B/6P Dwelling	GIA
Ground Floor	- 56.43m2
First Floor	- 53.32m2
Total	- 109.75m2

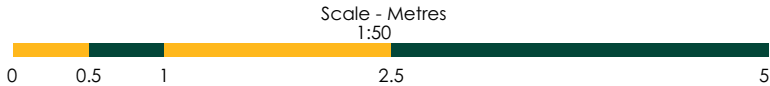

Revision C - 12/04/19 - Revised Planning Issue
Revision B - 06/02/19 - Updated to suit revised layout
PLANNING APPLICATION

BERRYS
PROPERTY BUSINESS PLANNING
01432 809835 | HR4 9AR
www.berrys.uk.com

Client: Mr and Mrs Davies
Project: Proposed Housing Development at Former Nursery Site at Lingen, Herefordshire

Drawing: Proposed Floor Plans - Plot 3

Drawing No:	Scale	Paper	Drawn By:	Date
HA28664_P19-C	1:50	A3	RJP-S	Oct 2018