

new drop kerb to entrance and continuous footpath constructed to improve pedestrian safety as per Herefordshire Council Highways design guide for vehicular crossing construction (see table adjacent)

Vehicular Crossing Construction

	nom. size	materials	compacted thickness
surface course	6mm	AC 6 dense surf 100/150 to DfT SHW Clause 909	25mm
binder course	20mm	AC 20 dense bin 100/150 rec conforming to DfT SHW 906	60mm
base course	32mm	AC 32 dense base 100/150 to DfT SHW 906	100mm
sub-base		Type 1 sub base conforming to DfT SHW Clause 803- Thickness may be increased depending on CBR values	150mm

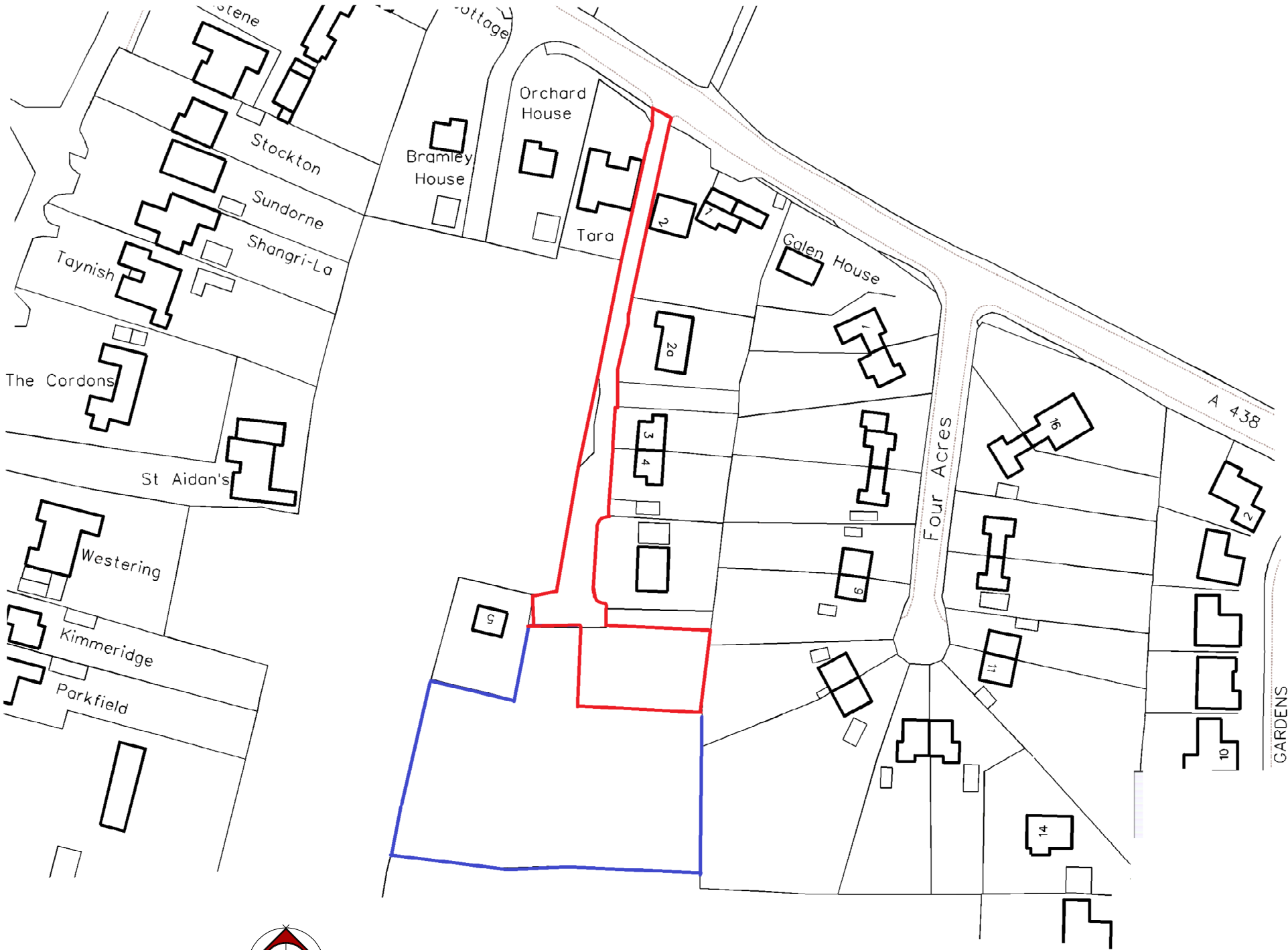

Site Locaion Plan (1:1250)

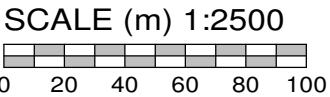
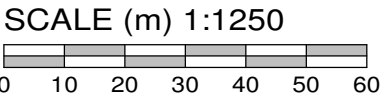
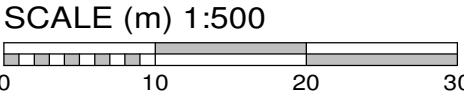
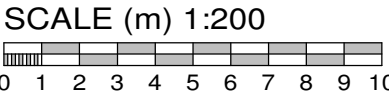
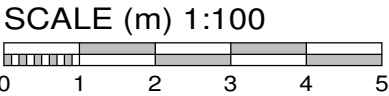
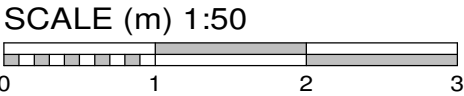

All figure dimensions and levels must be checked on site. Do not scale dimensions or levels from this drawing for the purpose of setting out or ordering components. If in doubt check with the consultant. All scales are as indicated below.

All drainage used by more than one dwelling is now a public sewer, if not previously adopted, and any building over or within 3 metres may require a "building over agreement" with Welsh Water. It will be the responsibility of the client to enter into this agreement.

Revisions		
	date	details
A	23.09.20	amendments for highways
B	23.10.20	adjacent garage added

scales 1:500 (A2 print)

date 14.04.16 drawn by AG/jp

title	
Proposed Dwelling	
Cherry Orchard	
Hereford	
client	
A Griffiths	

drawing no.	rev.
434-10	B

© copyright

**A G D**

Water Villas  
Wellington  
Hereford

07507 628747