

# Sewage Treatment Plant with Seasonal Soakaway

## Plan submitted

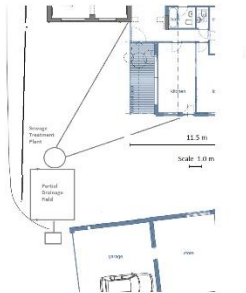

## Current STP

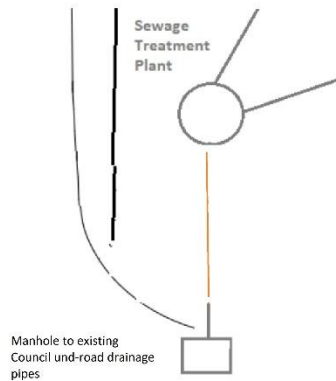

## Seasonal Soakaway

## Partial Drainage Field

## Proposed PDF

110mm slotted drainage pipe  
Fall of 1:200  
Laid on 25mm gravel bed

Covering of ~600mm soil  
Copious hedging and trees on  
adjoining boundary

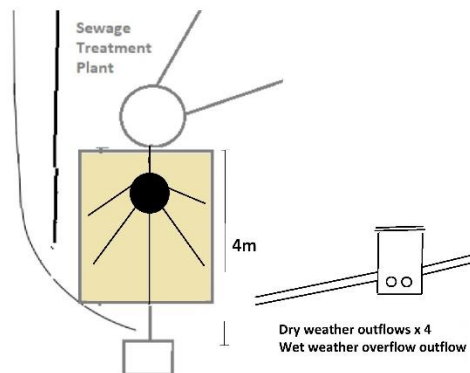

Distribution unit



Existing outflow from STP  
Upstream  
Distribution unit Gravel  
Slotted outflow pipes



Existing outflow from STP  
Downstream

Distribution unit Modified Polypipe inspection chamber

Dry weather outflow to 4 low-level outlets to seasonal soakaway slotted pipes

Wet weather outflow to 1 high-level outlet to watercourse