

Scale at 1:5 - 250mm, 1:10 - 500mm,
1:20 - 1.0m, 1:50 - 2.5m, 1:100 - 5.0m,
1:200 - 10m, 1:500 - 25m

Dimensions of wall thicknesses are
finished dimensions

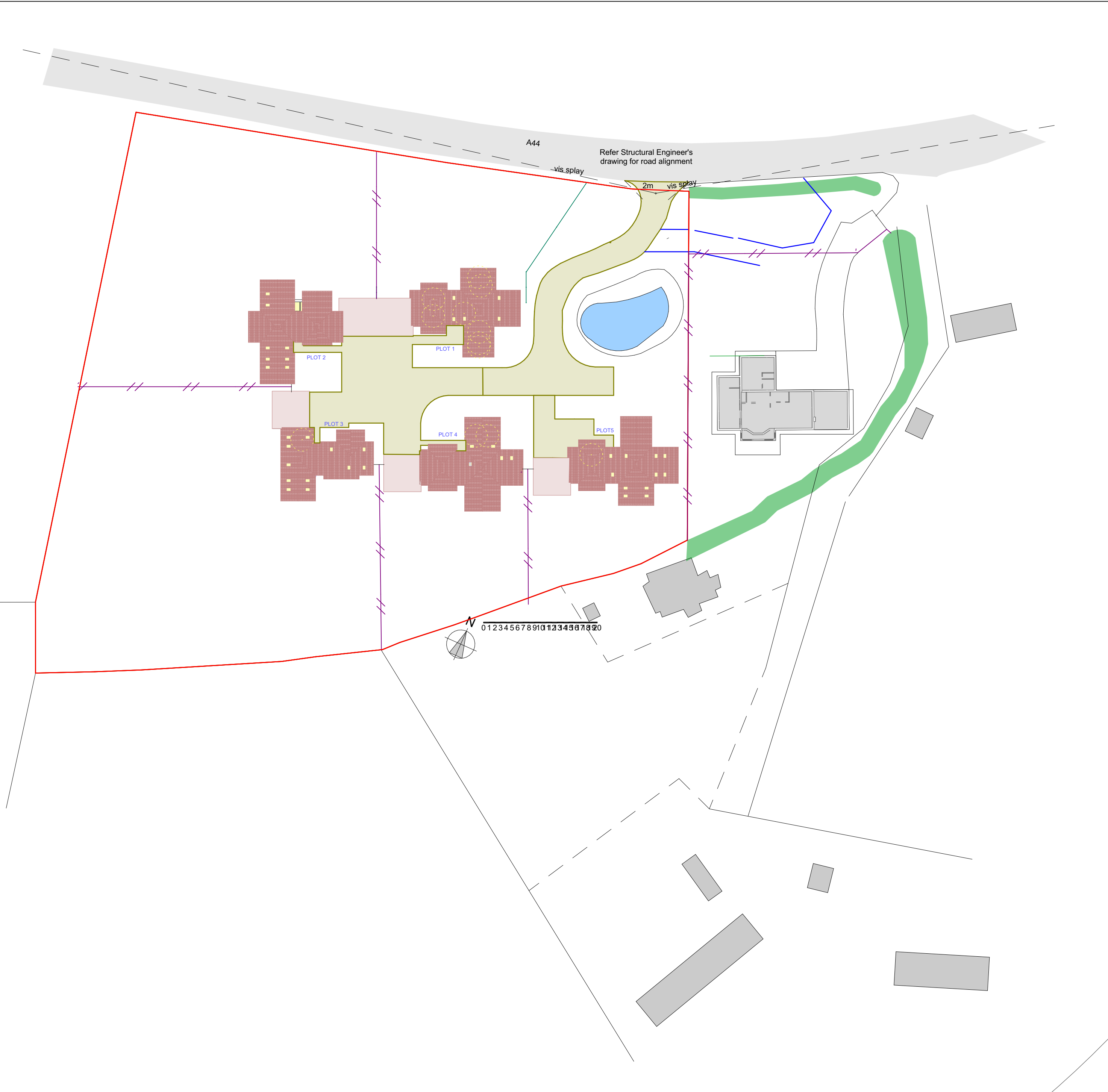

Rev A 2022-08-30 Updated

Rev	Date	Chk
-----	------	-----

PETER HUNT
ARCHITECTS
Hunters Moon, Gorse Green Lane
Belbroughton Worcs DY9 9UH
Tel: 08454 300 200
Email: projects16@peterhunt.uk.net

Client
Aspire Developments UK Ltd

Job Title
Proposed Housing

The Bannut
Bromyard Rd
Bringsty
WR6 5TA

Drawing Name
Block Plan Proposed

Drawing Status
Feasibility

CAD File Ref 20-887 Banut D07.pln

This drawing is Copyright and is the property of Peter Hunt Architects. It has been produced for this specific project and client as indicated and is not intended for use by any other person or for any other purpose. During construction, work to figured dimensions only - do not scale. If in doubt ask. Only the original drg should be relied on.

Drawn by
Date

Check'd by
Date

Drawing Scale
1:500

Drwg Size
A2

Project No
20-887

Drawing No - Revision
202-A