

TYPICAL VERGE DETAIL - SLATE ROOF

BARN A & BARN B

notes
this drawing is copyright | do not scale off this drawing |
dimensions to be checked on site | any discrepancies
to be reported to the architect immediately

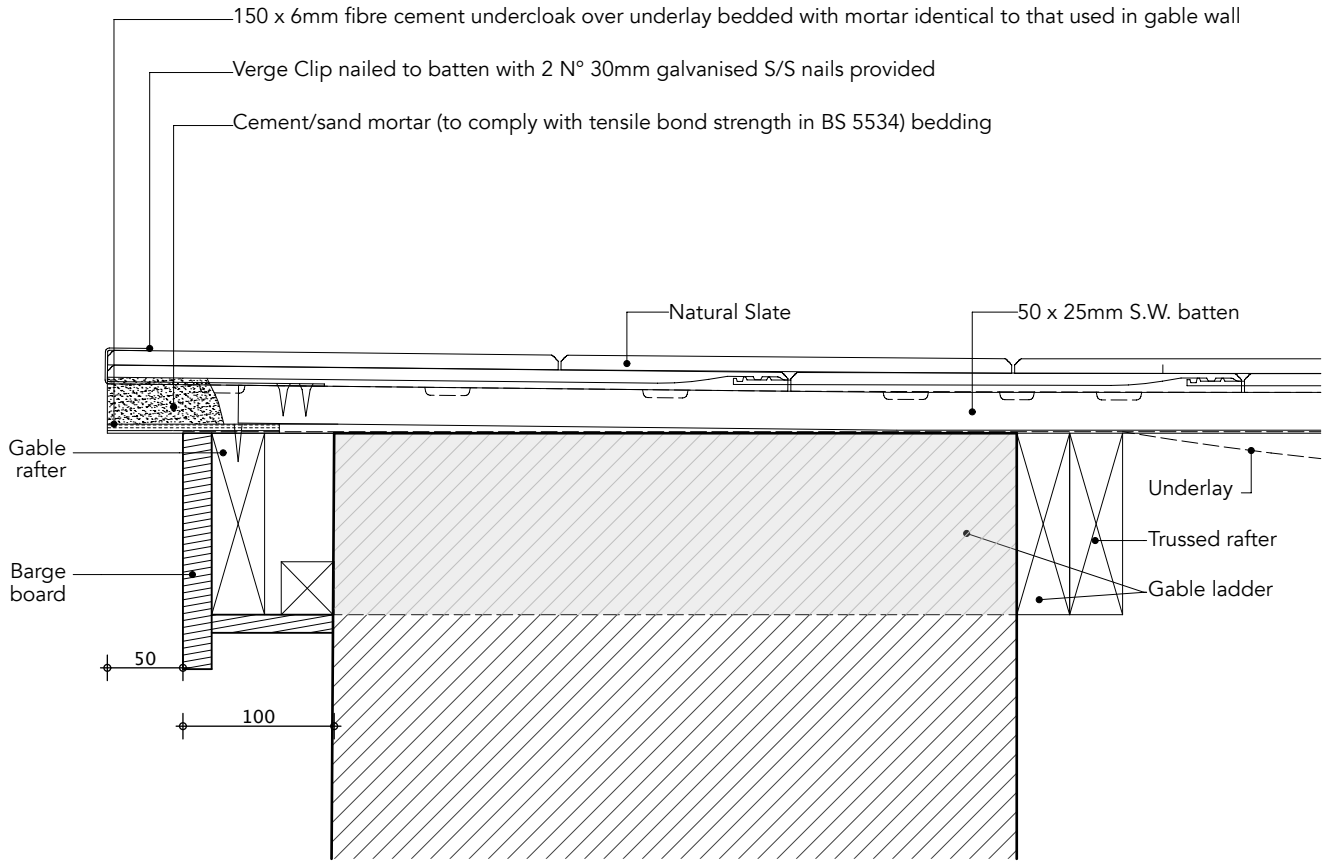

- OVERHANGING MORTAR BEDDED VERGE
- * Ensure that gable wall and gable ladder are constructed level with top of rafters.
 - * Carry underlay over full width of verge to outer face of barge board.
 - * Place 6mm fibre cement undercloak of approved colour over underlay and projecting 50mm beyond face of bargeboard , and fix to gable rafter with 25mm galvanised clout nails.
 - * Finish tiling battens at centre of gable rafter and properly fix to rafters and gable rafter.
 - * Fix slates every course at verge with Verge Clips twice nailed to tiling battens with 30 x 2.65mm galvanised clout nails.
 - * Bed edge of all slates at verge, on a 75mm wide bed of mortar as clause 290, ensuring that mortar is not displaced or cracked by mechanical fixing of slates.

rev	date	description	int'l
-----	------	-------------	-------

OHA

OWEN HICKS ARCHITECTURE

Studio B3 | Skylon Court
Hereford | HR2 6JS
T 01432 261 152
info@oha-architecture.co.uk
www.oha-architecture.co.uk

client

RIVERSIDE CONSTRUCTION

project

PROPOSED DEVELOPMENT
HOLMER HOUSE FARM
HOLMER
HEREFORD

drawing

TYPICAL VERGE
DETAIL- SLATE ROOF

scale	date	drawn
1:5@A3	FEB 2022	ZC

project nos.	status
2021.057 / 7.03	PLANNING

drawing nos.	revision
--------------	----------

AA 202