

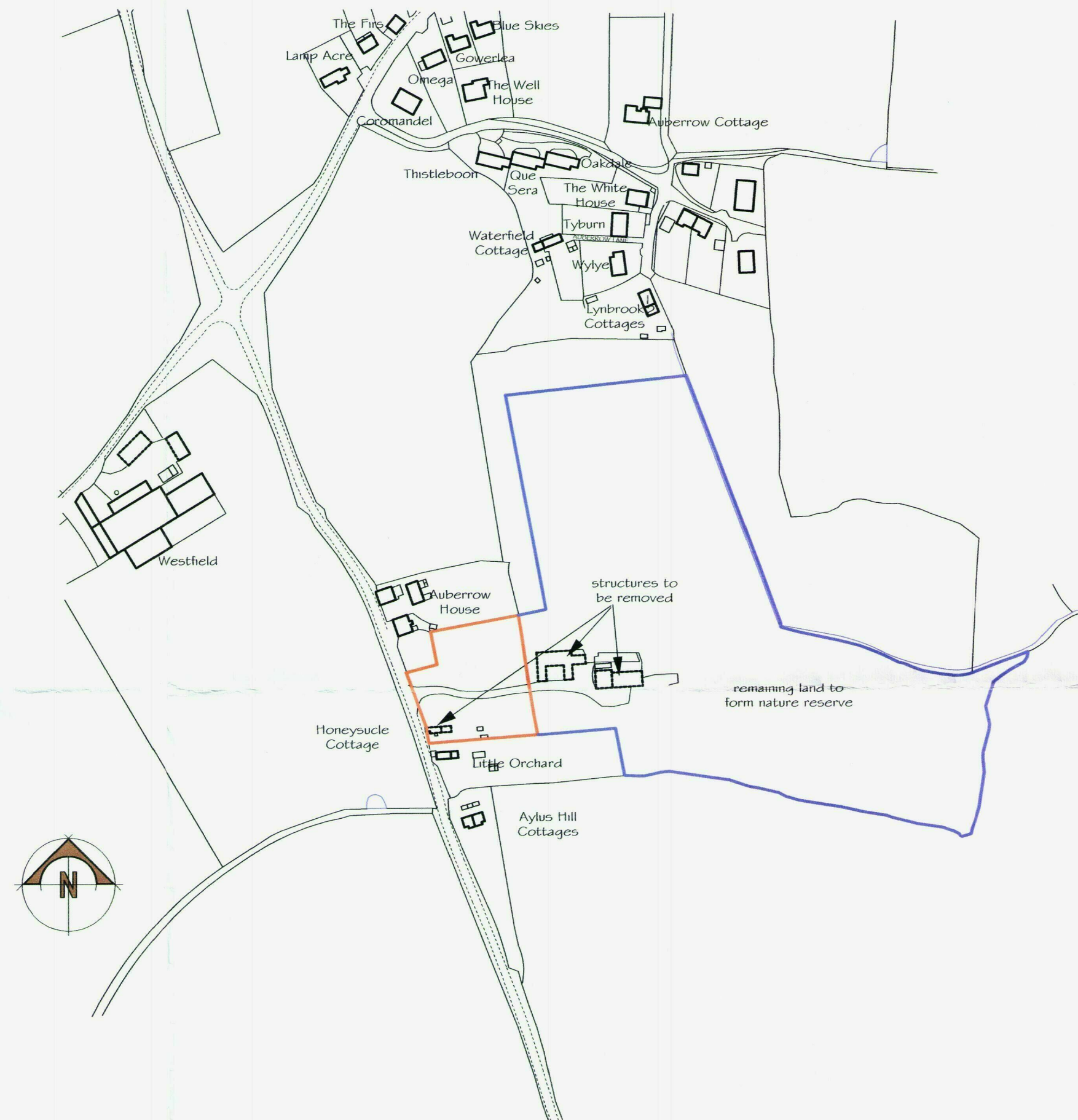

Block Plan (1:500)
(indicative layout only)



Location Plan (1:2500)

HEREFORDSHIRE COUNCIL
PLANNING SERVICES
DEVELOPMENT CONTROL
13 AUG 2019
To:
Ack'd: File:

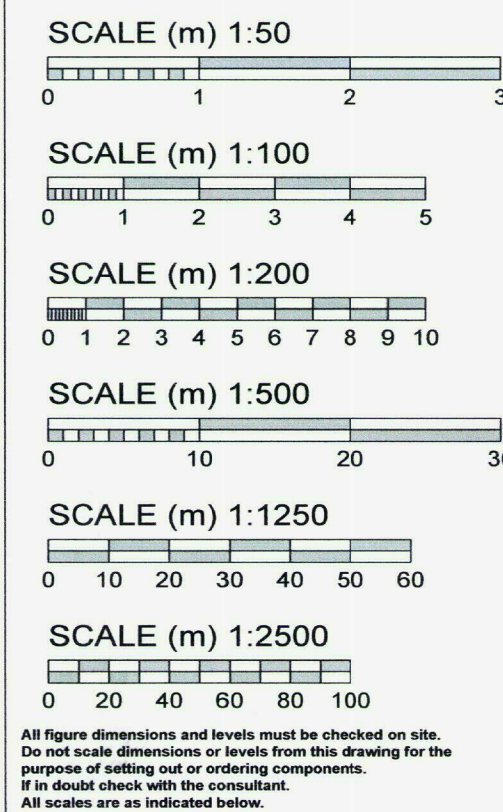

Revisions

date	details

scales 1:500 1:2500(A2 print)

date 12.09.18 drawn by AG/jp

title
Proposed Development
land at
Poultry Lane
Wellington
Hereford

provisional

client
The Late Mr Davies

drawing no.
1401-1

rev.
□

© copyright

John Phipps
Architectural Consultant

Bank Lodge
Coldwells Road Holmer Hereford HR1 1LH
01432 276424
Email: johnhipps@ukgateway.net