

0 10 20 30 40 50
When reproduced correctly at 1:1 this scale
should be accurate in millimetres

NOTE:

All works to be carried out in accordance with relevant British and European Standards and Codes of Practice. All products to be used in accordance with manufacturer's recommendations and applicable BBA certificates. Any conflicts to be notified to architect at earliest opportunity.

This drawing to be read in conjunction with all relevant Architect's and other Specialist's drawings, details and specifications.

Significant risks are not necessarily those that involve the greatest risks, but those, including health risks that are:
a) not likely to be obvious to a competent contractor or other designers;
b) unusual; or
c) likely to be difficult to manage effectively.

Significant Health and Safety Risks:

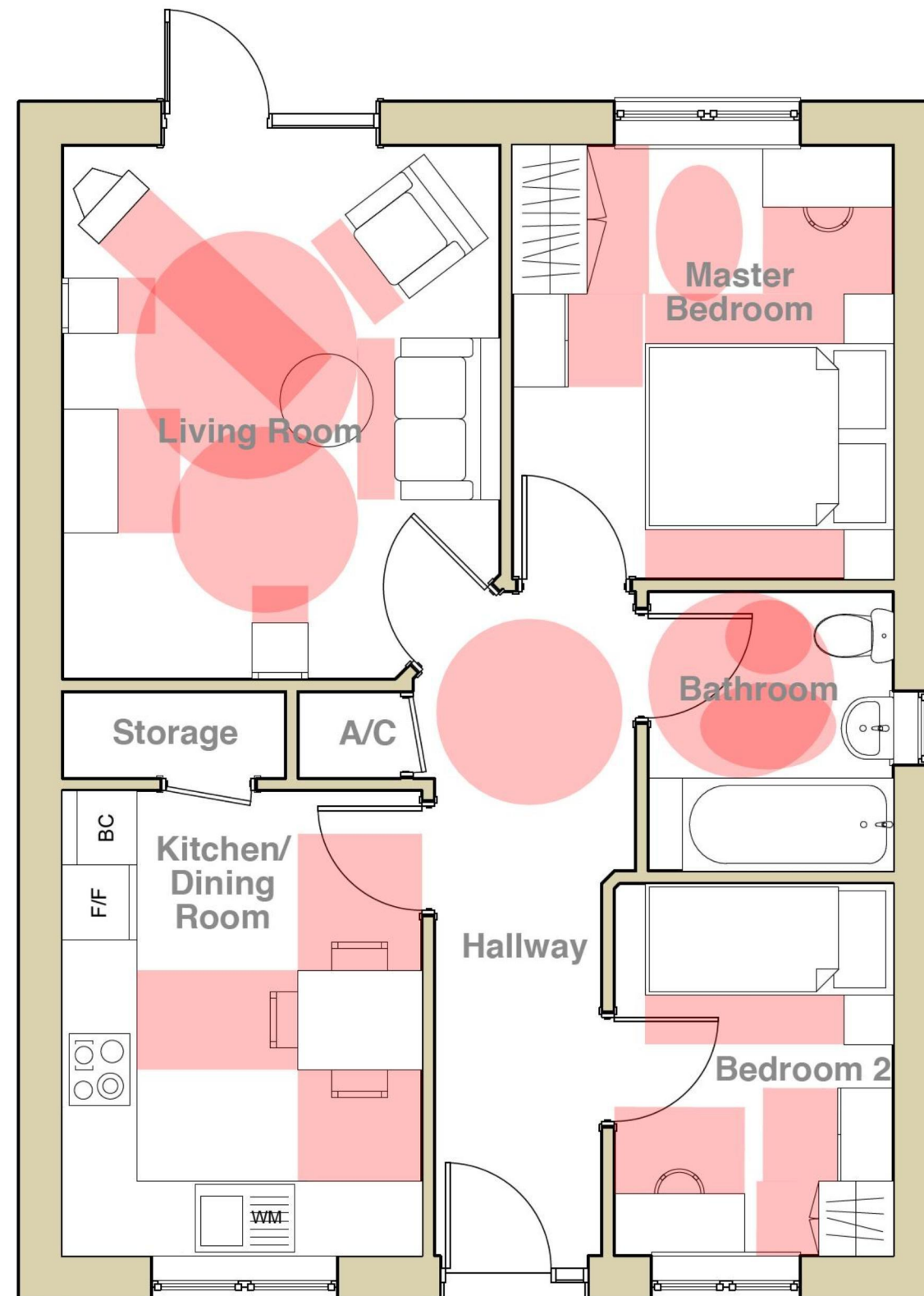

60 sq.m

Ground Floor (Type J)

1:50

A 11.12.2013 KD
Status revised to Planning.

Signature
new homes

Residential
Development,
Whitbourne

Type J - 2
Bedroom
Bungalow (Rent)

Drawn: MSW 25.10.2013

Checked: _____
Approved For issue: _____

Quality
Drawing Format A3 pdf ☐ plt ☐ dwg ☐

Drawing Scale 1:50

Drawing Status PLANNING

DJD Architects
2 St Oswald's Road
Worcester WR1 1HZ
t: 01905 612864
f: 01905 610011
mail@djdgroup.co.uk
www.djdgroup.co.uk/architects/
DO NOT SCALE
DIMENSIONS TO BE CHECKED ON
SITE
THIS DRAWING IS COPYRIGHT AND
MAY NOT BE REPRODUCED WITHOUT
WRITTEN CONSENT.

Drawing Number and Revision:
2012/K532/69(A)