

Amenities Building (9m x 3.5m)

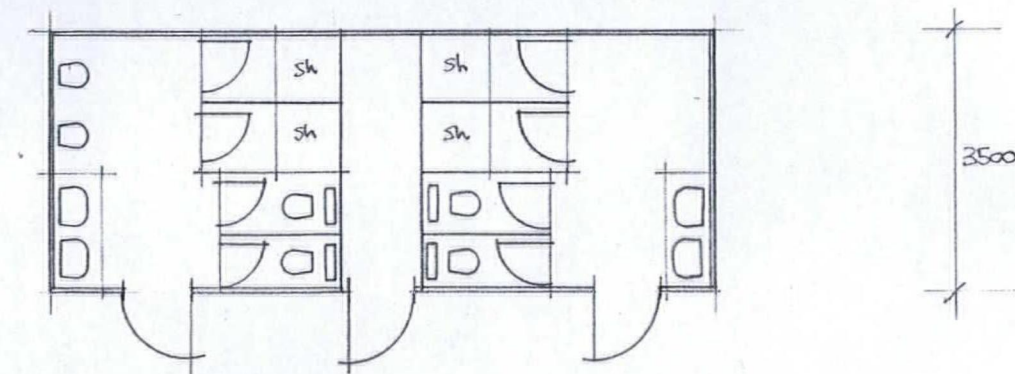

Floor plan

1:100

The copyright of this drawing belongs to Christopher F. Knock.
Do not scale off this drawing.

Date:	Revisions:	
22 Jan 2018	Orientation	A

HEREFORDSHIRE COUNCIL
PLANNING SERVICES
DEVELOPMENT CONTROL

05 FEB 2018

To _____
Ack'd _____ File _____

Christopher F. Knock
B. Sc. (Civil Engineering)
Architectural & Planning Consultant

Tel: 01531 635462
Email: chris@christopherknock.co.uk

Tinkers Grove Cottage
The Deer Park, Eastnor,
Nr. Ledbury
Herefordshire. HR8 1RQ

JOB TITLE: Land adjacent Playford, Much Marcle, Ledbury, Herefordshire HR8 2NN
For Mr and Mrs J. Rennick. Proposed camp site and temporary dwelling.

DRAWN BY: C. F. Knock

DRAWING TITLE: Floor plan & elevations
Amenity Building

DATE: 19th August 2017 SCALE: 1:100 A3 DRAWING NO: 1317:1827:04 A