

NOTES

This drawing is the copyright of Thrive Ltd ©. All rights reserved.
Ordnance Survey Data © Crown Copyright. All rights reserved.
Licence No. 100007359. DO NOT scale from this drawing.
Contractors, Sub Contractors and Suppliers are to check all relevant dimensions and levels of the site and building before commencing any shop drawings or building work. Any discrepancies should be recorded to the Architect.
Where applicable this drawing is to be read in conjunction with the Consultants' drawings.

REV	DESCRIPTION	DATE	AUTH	CHK'D
A	Planning issue.	07.12.17	HG	

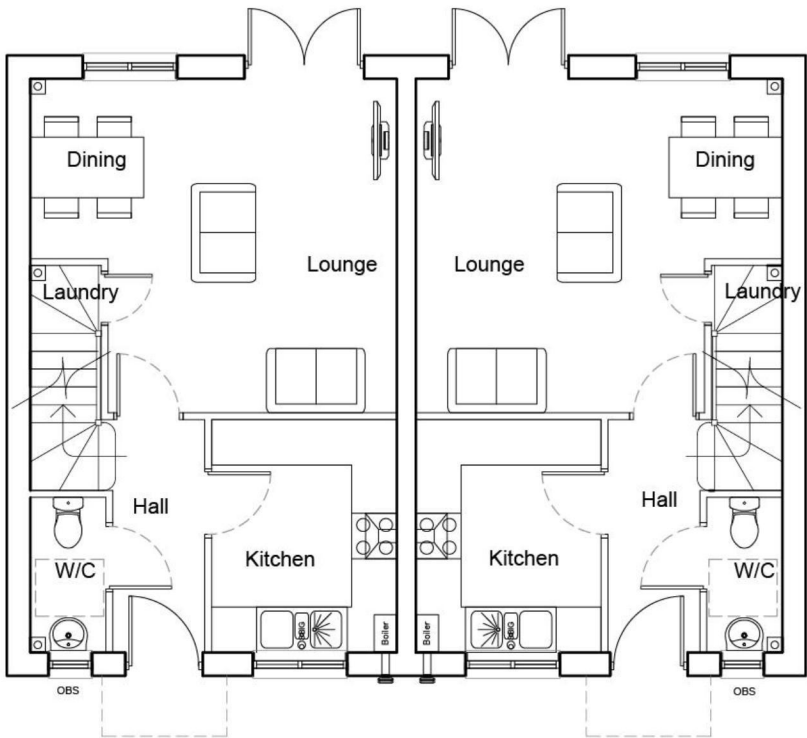

Ground Floor Plan

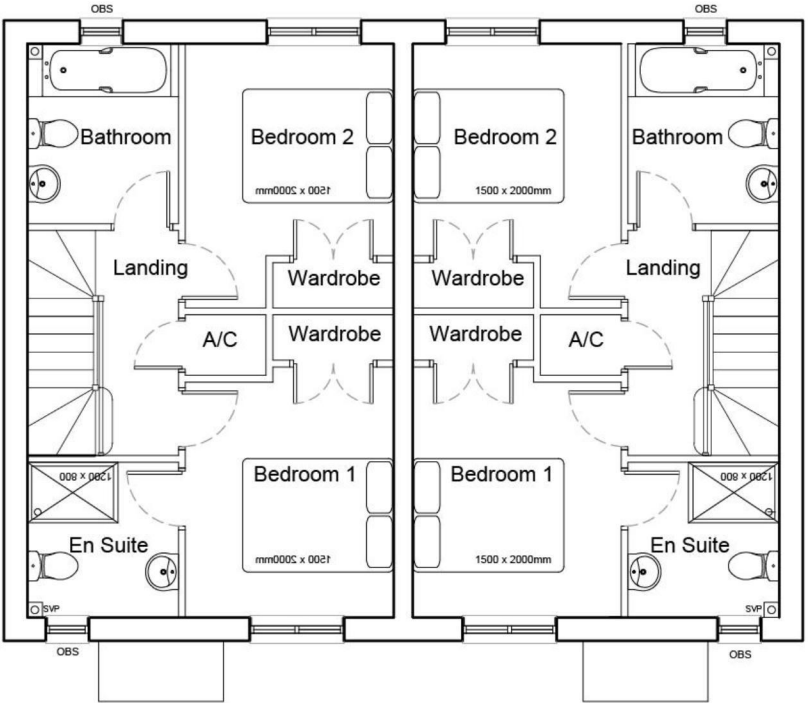

First Floor Plan



PLANNING



architects

Romsey Office

Building 300, The Grange, Romsey Road, Michelmersh, SO51 0AE
t: 01794 367703 f: 01794 367276 www.thrivearchitects.co.uk

PROJECT

Land at Weston-under-Penyard

Herefordshire

For: M F Freeman

DRAWING

House Type Hornby

Floor Plans

SCALE	DATE	AUTHOR	CHK'D
1:100 @ A3	10.08.16	ND	
JOB NO.	DRAWING NO.	REV	
MFFR150924	HT.HORN.p	A	
CLIENT REF.			

House type	Hornby	Variation	
Bedrooms	2	Persons	4
Sq.ft	780	Sq.m	72.46

PLOT No.
As Drawn - 26-27,28-29