

Appendix F Historical Maps

Historical Mapping Legends

Ordnance Survey County Series and Ordnance Survey Plan 1:2,500

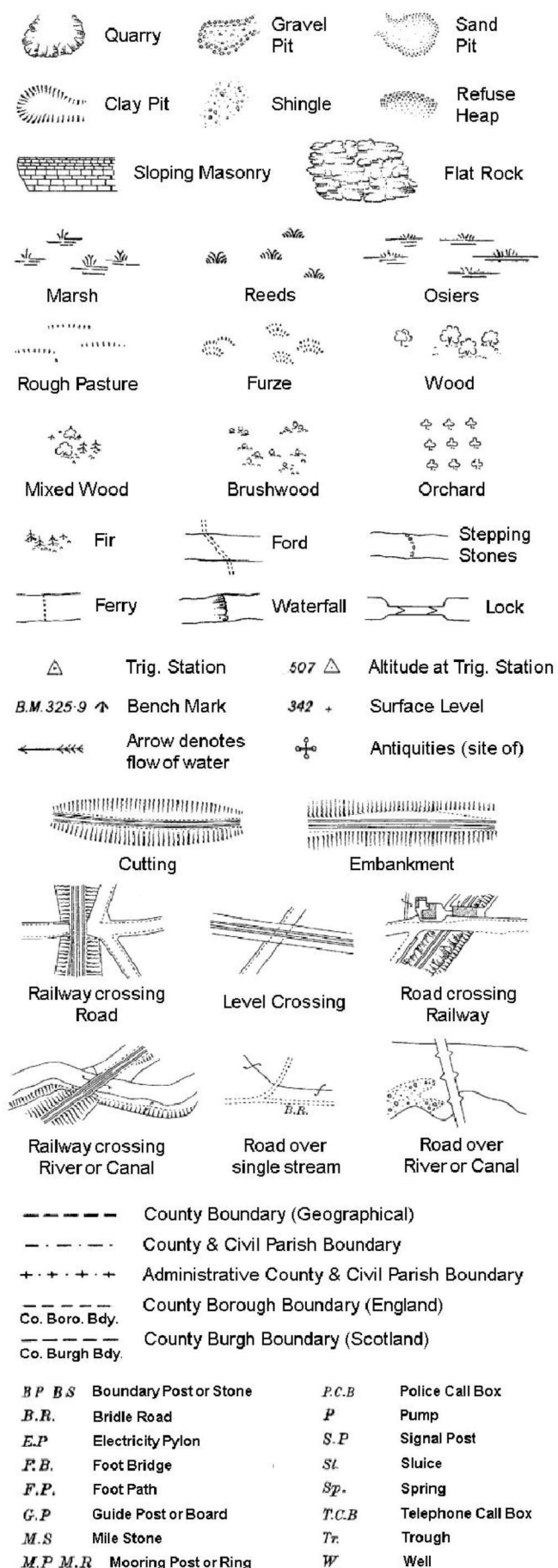

Ordnance Survey Plan, Additional SIMs and Supply of Unpublished Survey Information 1:2,500 and 1:1,250

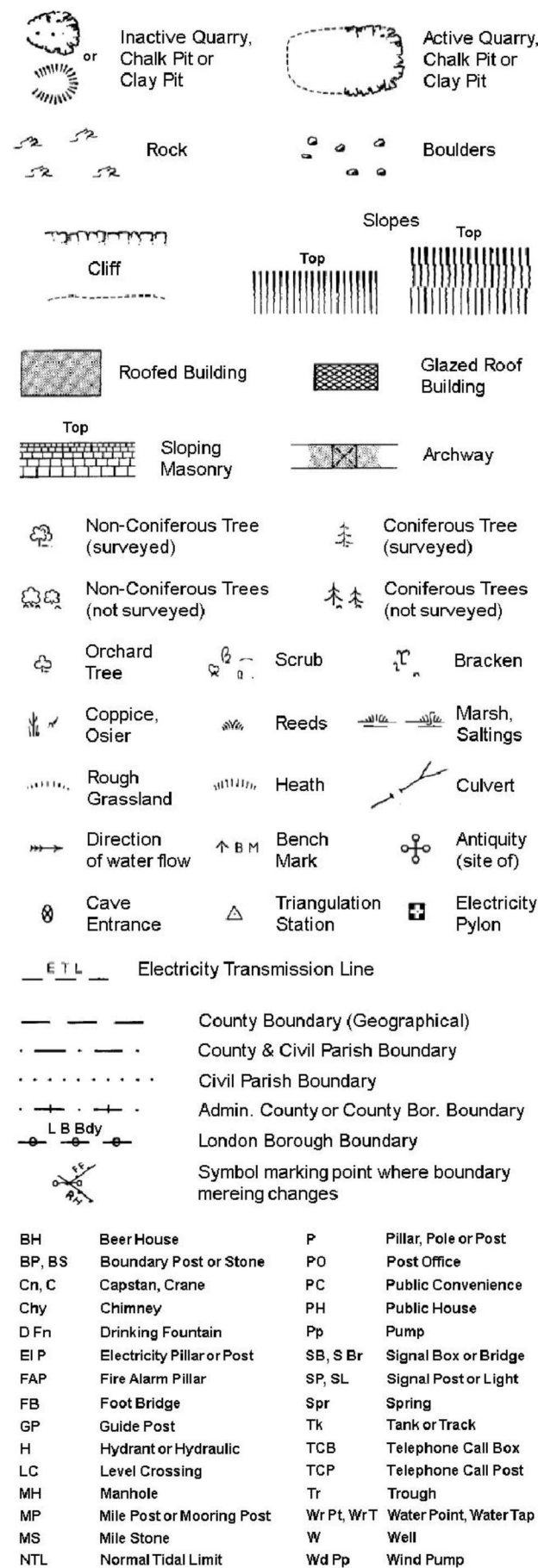

Large-Scale National Grid Data 1:2,500 and 1:1,250

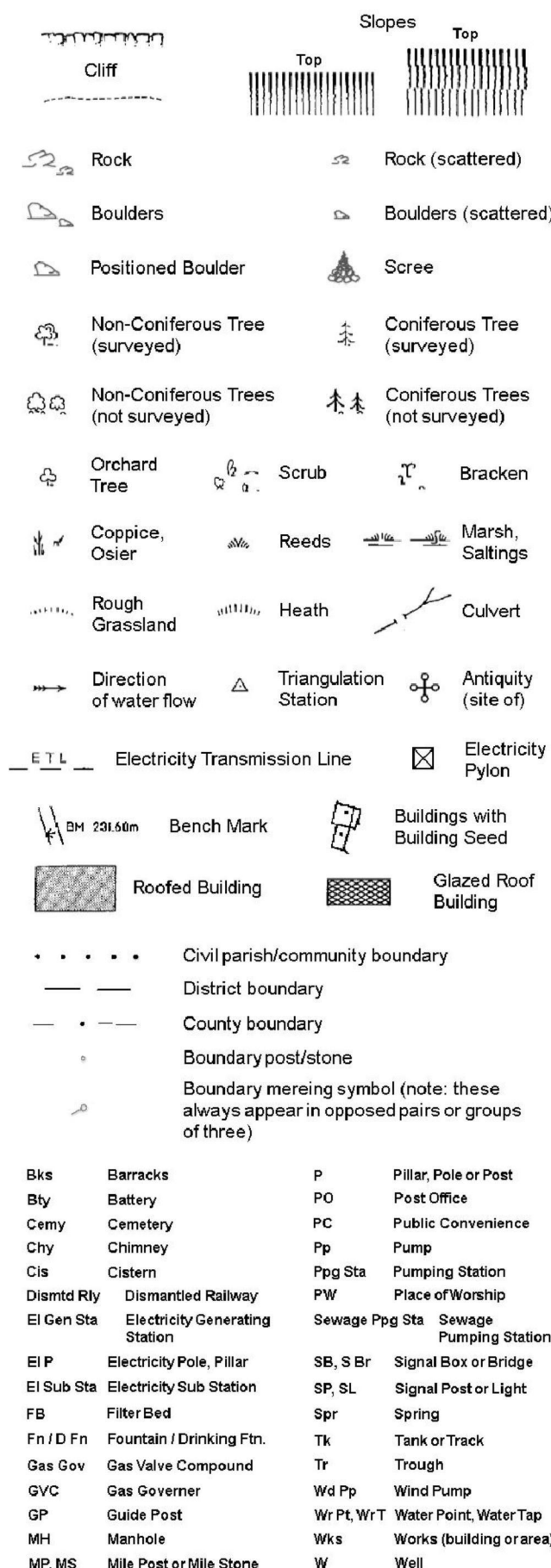

Historical Mapping & Photography included:

Mapping Type	Scale	Date	Pg
Herefordshire	1:2,500	1887	2
Herefordshire	1:2,500	1904	3
Herefordshire	1:2,500	1928	4
Ordnance Survey Plan	1:2,500	1967 - 1968	5
Supply of Unpublished Survey Information	1:2,500	1974	6
Supply of Unpublished Survey Information	1:2,500	1975	7
Additional SIMs	1:2,500	1977 - 1986	8
Ordnance Survey Plan	1:2,500	1983 - 1991	9
Additional SIMs	1:2,500	1983 - 1989	10
Ordnance Survey Plan	1:2,500	1989	11
Additional SIMs	1:2,500	1989 - 1993	12
Additional SIMs	1:2,500	1992	13
Large-Scale National Grid Data	1:2,500	1995	14
Large-Scale National Grid Data	1:2,500	1995 - 1996	15
Large-Scale National Grid Data	1:2,500	1996 - 1997	16

Historical Map - Segment A13

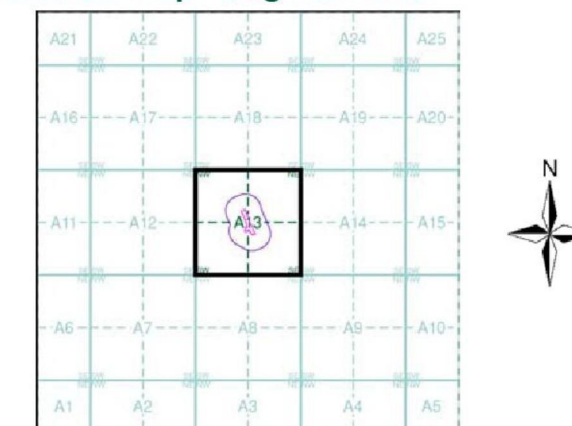

Order Details

Order Number: 41277440_1_1
 Customer Ref: EMS3512
 National Grid Reference: 350090, 259080
 Slice: A
 Site Area (Ha): 0.48
 Search Buffer (m): 100

Site Details

Pinsley Mill, Pinsley Road, Leominster, HR6 8NN

Herefordshire

Published 1887

Source map scale - 1:2,500

The historical maps shown were reproduced from maps predominantly held at the scale adopted for England, Wales and Scotland in the 1840's. In 1854 the 1:2,500 scale was adopted for mapping urban areas and by 1896 it covered the whole of what were considered to be the cultivated parts of Great Britain. The published date given below is often some years later than the surveyed date. Before 1938, all OS maps were based on the Cassini Projection, with independent surveys of a single county or group of counties, giving rise to significant inaccuracies in outlying areas.

Map Name(s) and Date(s)

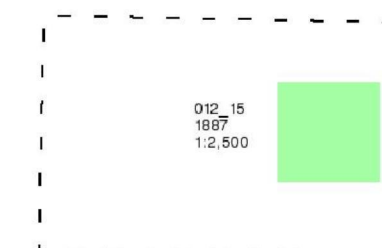

Historical Map - Segment A13

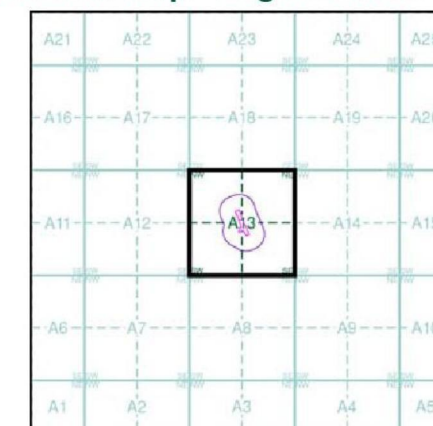

Order Details

Order Number: 41277440_1_1
Customer Ref: EMS3512
National Grid Reference: 350090, 259080
Slice: A
Site Area (Ha): 0.48
Search Buffer (m): 100

Site Details

Pinsley Mill, Pinsley Road, Leominster, HR6 8NN

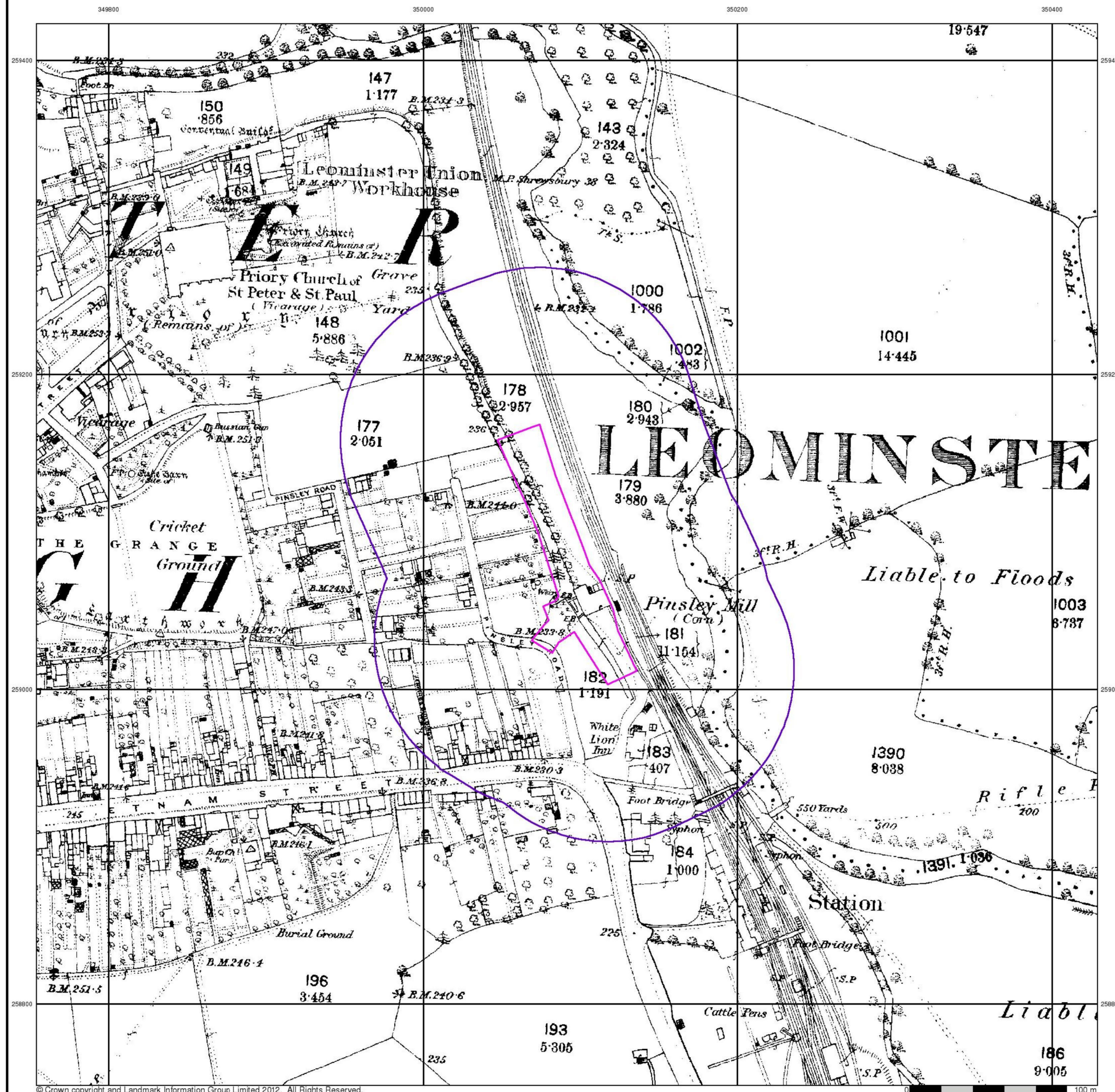

Herefordshire

Published 1904

Source map scale - 1:2,500

The historical maps shown were reproduced from maps predominantly held at the scale adopted for England, Wales and Scotland in the 1840's. In 1854 the 1:2,500 scale was adopted for mapping urban areas and by 1896 it covered the whole of what were considered to be the cultivated parts of Great Britain. The published date given below is often some years later than the surveyed date. Before 1938, all OS maps were based on the Cassini Projection, with independent surveys of a single county or group of counties, giving rise to significant inaccuracies in outlying areas.

Map Name(s) and Date(s)

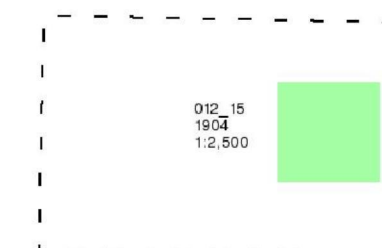

Historical Map - Segment A13

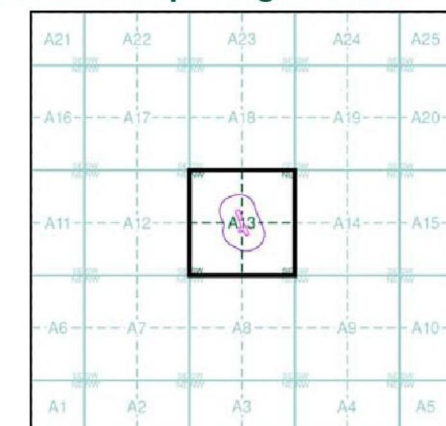

Order Details

Order Number: 41277440_1_1
 Customer Ref: EMS3512
 National Grid Reference: 350090, 259080
 Slice: A
 Site Area (Ha): 0.48
 Search Buffer (m): 100

Site Details

Pinsley Mill, Pinsley Road, Leominster, HR6 8NN

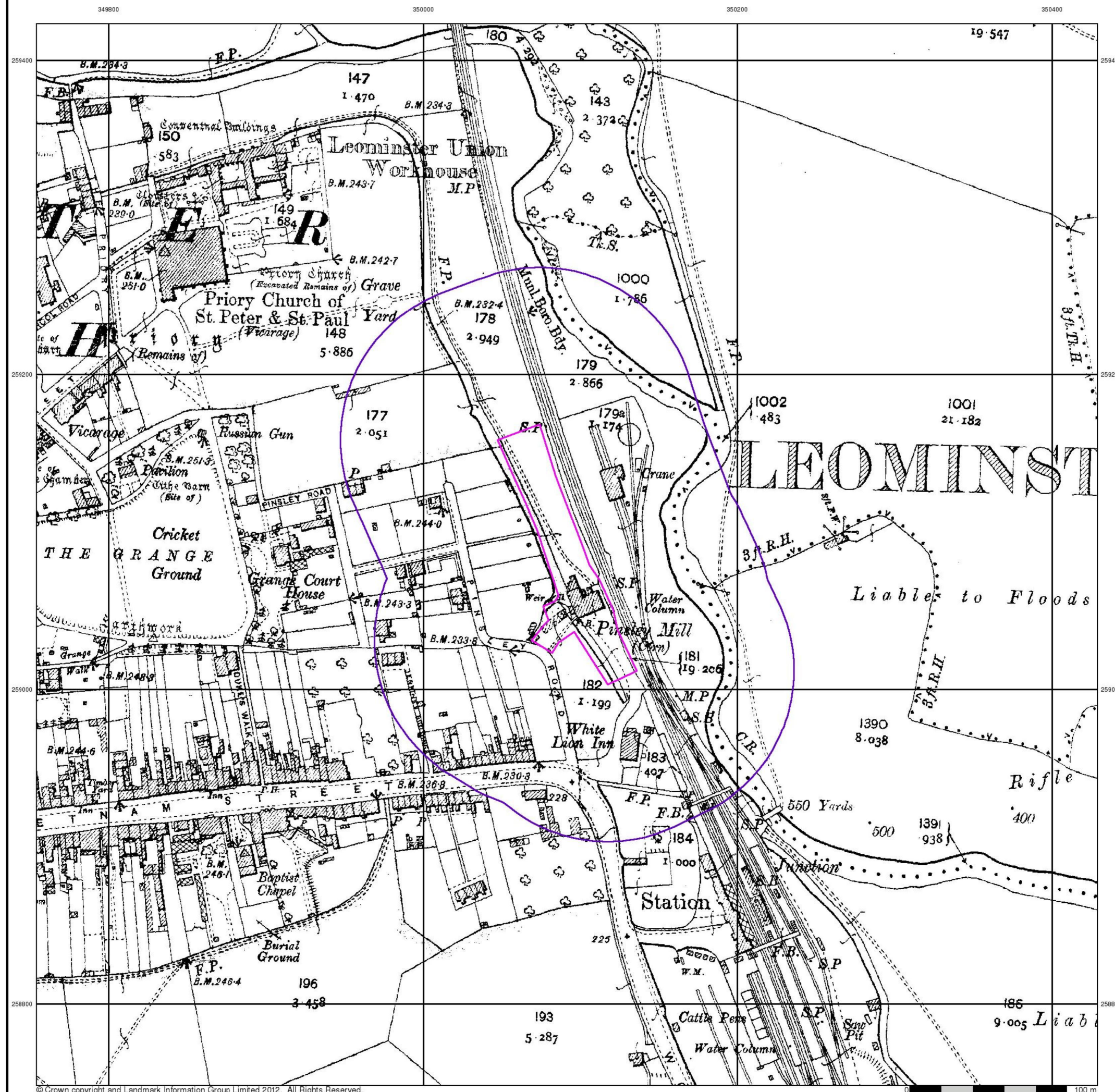

Herefordshire

Published 1928

Source map scale - 1:2,500

The historical maps shown were reproduced from maps predominantly held at the scale adopted for England, Wales and Scotland in the 1840's. In 1854 the 1:2,500 scale was adopted for mapping urban areas and by 1896 it covered the whole of what were considered to be the cultivated parts of Great Britain. The published date given below is often some years later than the surveyed date. Before 1938, all OS maps were based on the Cassini Projection, with independent surveys of a single county or group of counties, giving rise to significant inaccuracies in outlying areas.

Map Name(s) and Date(s)

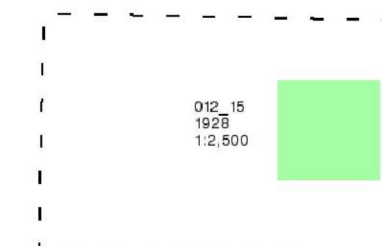

Historical Map - Segment A13

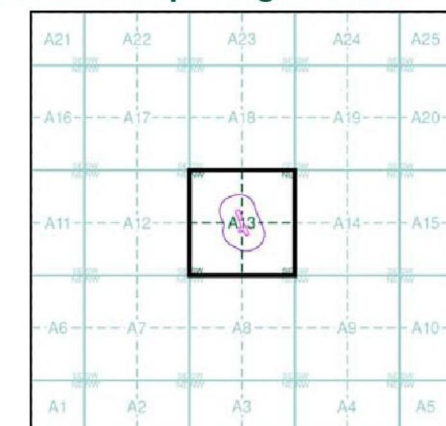

Order Details

Order Number: 41277440_1_1
Customer Ref: EMS3512
National Grid Reference: 350090, 259080
Slice: A
Site Area (Ha): 0.48
Search Buffer (m): 100

Site Details

Pinsley Mill, Pinsley Road, Leominster, HR6 8NN



Ordnance Survey Plan

Published 1967 - 1968

Source map scale - 1:2,500

The historical maps shown were reproduced from maps predominantly held at the scale adopted for England, Wales and Scotland in the 1840's. In 1854 the 1:2,500 scale was adopted for mapping urban areas and by 1896 it covered the whole of what were considered to be the cultivated parts of Great Britain. The published date given below is often some years later than the surveyed date. Before 1938, all OS maps were based on the Cassini Projection, with independent surveys of a single county or group of counties, giving rise to significant inaccuracies in outlying areas.

Map Name(s) and Date(s)

SO4959 1968 1:2,500	SO5059 1968 1:2,500
SO4958 1968 1:2,500	SO5058 1967 1:2,500

Historical Map - Segment A13

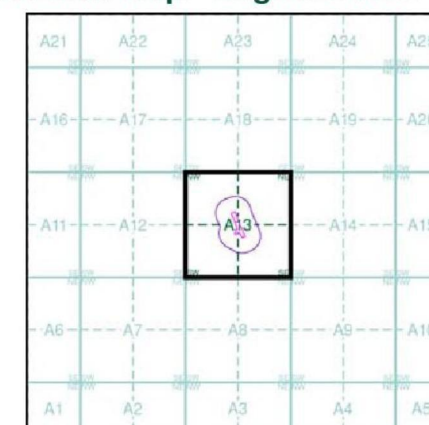

Order Details

Order Number: 41277440_1_1
 Customer Ref: EMS3512
 National Grid Reference: 350090, 259080
 Slice: A
 Site Area (Ha): 0.48
 Search Buffer (m): 100

Site Details

Pinsley Mill, Pinsley Road, Leominster, HR6 8NN

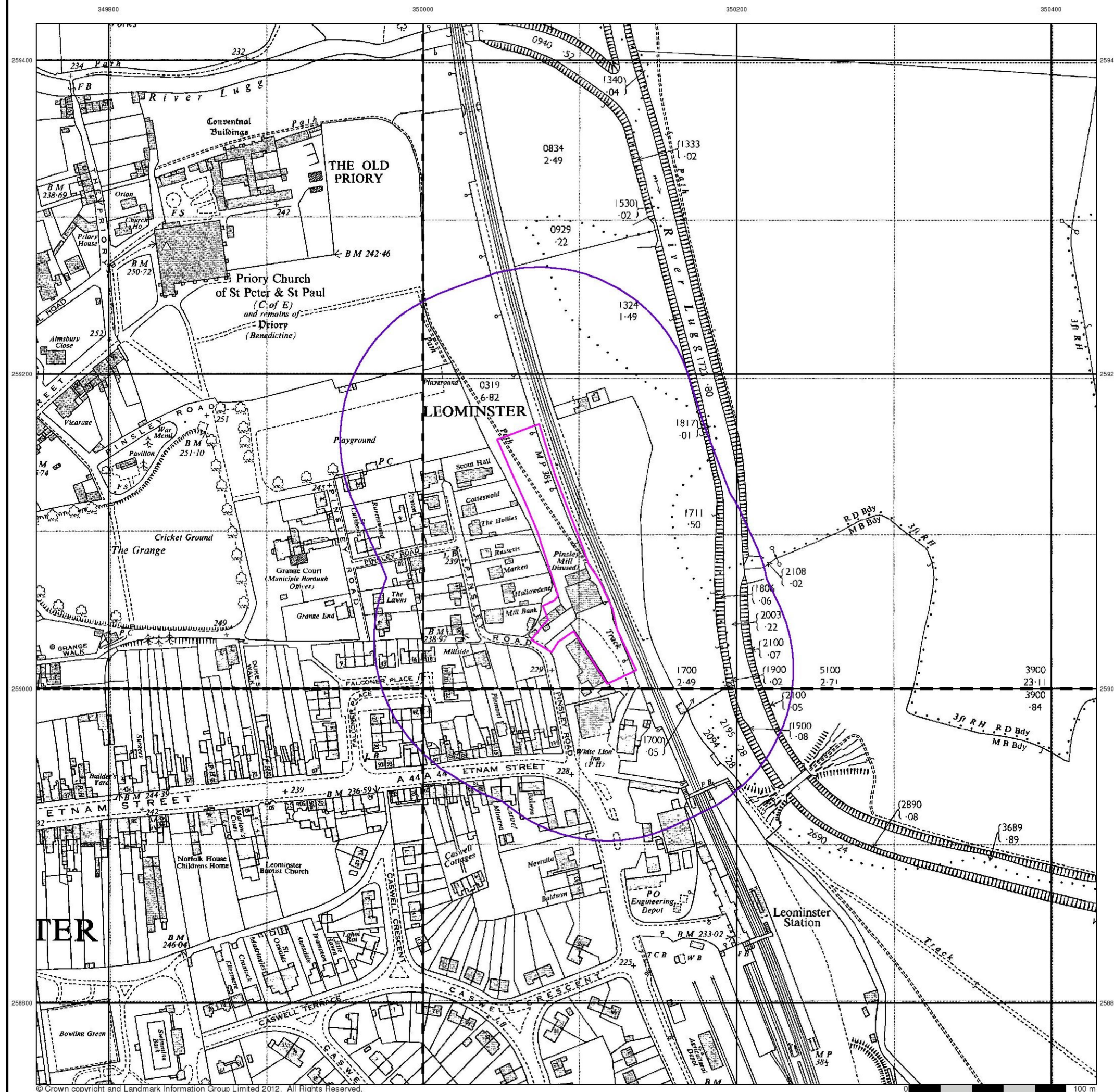

Supply of Unpublished Survey Information

Published 1974

Source map scale - 1:2,500

SUSI maps (Supply of Unpublished Survey Information) were produced between 1972 and 1977, mainly for internal use at Ordnance Survey. These were more of a 'work-in-progress' plan as they showed updates of individual areas on a map. These maps were unpublished, and they do not represent a single moment in time. They were produced at both 1:2,500 and 1:1,250 scales.

Map Name(s) and Date(s)

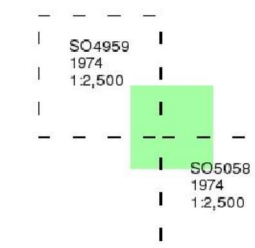

Historical Map - Segment A13

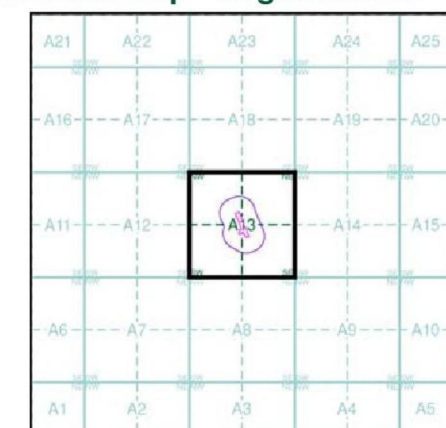

Order Details

Order Number: 41277440_1_1
 Customer Ref: EMS3512
 National Grid Reference: 350090, 259080
 Slice: A
 Site Area (Ha): 0.48
 Search Buffer (m): 100

Site Details

Pinsley Mill, Pinsley Road, Leominster, HR6 8NN



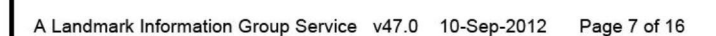

Additional SIMs

Published 1977 - 1986

Source map scale - 1:2,500

The SIM cards (Ordnance Survey's 'Survey of Information on Microfilm') are further, minor editions of mapping which were produced and published in between the main editions as an area was updated. They date from 1947 to 1994, and contain detailed information on buildings, roads and land-use. These maps were produced at both 1:2,500 and 1:1,250 scales.

Map Name(s) and Date(s)

SO4959	SO5059
1977	1986
1:2,500	1:2,500
SO4958	SO5058
1977	1977
1:2,500	1:2,500

Historical Map - Segment A13

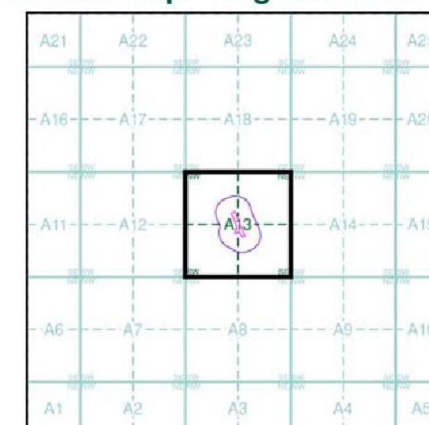

Order Details

Order Number: 41277440_1_1
 Customer Ref: EMS3512
 National Grid Reference: 350090, 259080
 Slice: A
 Site Area (Ha): 0.48
 Search Buffer (m): 100

Site Details

Pinsley Mill, Pinsley Road, Leominster, HR6 8NN

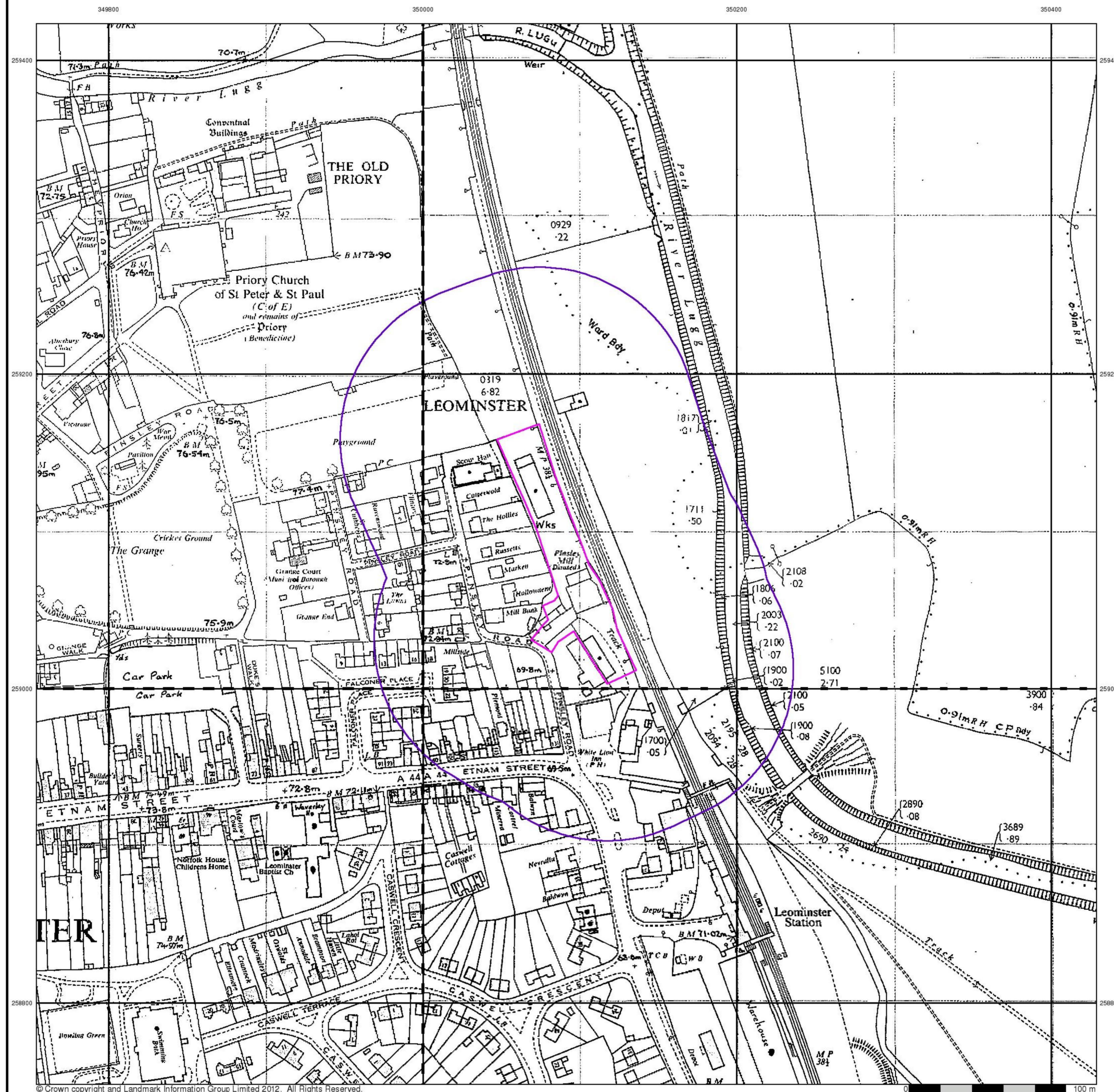

Ordnance Survey Plan

Published 1983 - 1991

Source map scale - 1:2,500

The historical maps shown were reproduced from maps predominantly held at the scale adopted for England, Wales and Scotland in the 1840's. In 1854 the 1:2,500 scale was adopted for mapping urban areas and by 1896 it covered the whole of what were considered to be the cultivated parts of Great Britain. The published date given below is often some years later than the surveyed date. Before 1938, all OS maps were based on the Cassini Projection, with independent surveys of a single county or group of counties, giving rise to significant inaccuracies in outlying areas.

Map Name(s) and Date(s)

SO4959	1983	1:2,500
SO4958	1984	1:2,500
SO5058	1991	1:2,500

Historical Map - Segment A13

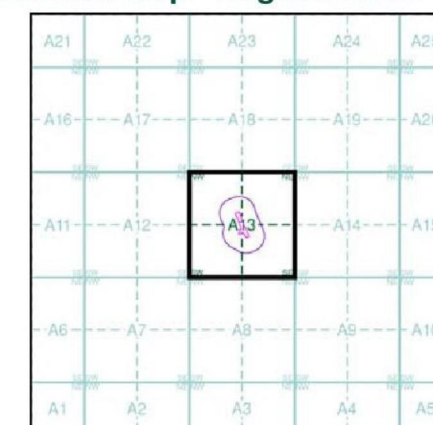

Order Details

Order Number: 41277440_1_1
 Customer Ref: EMS3512
 National Grid Reference: 350090, 259080
 Slice: A
 Site Area (Ha): 0.48
 Search Buffer (m): 100

Site Details

Pinsley Mill, Pinsley Road, Leominster, HR6 8NN

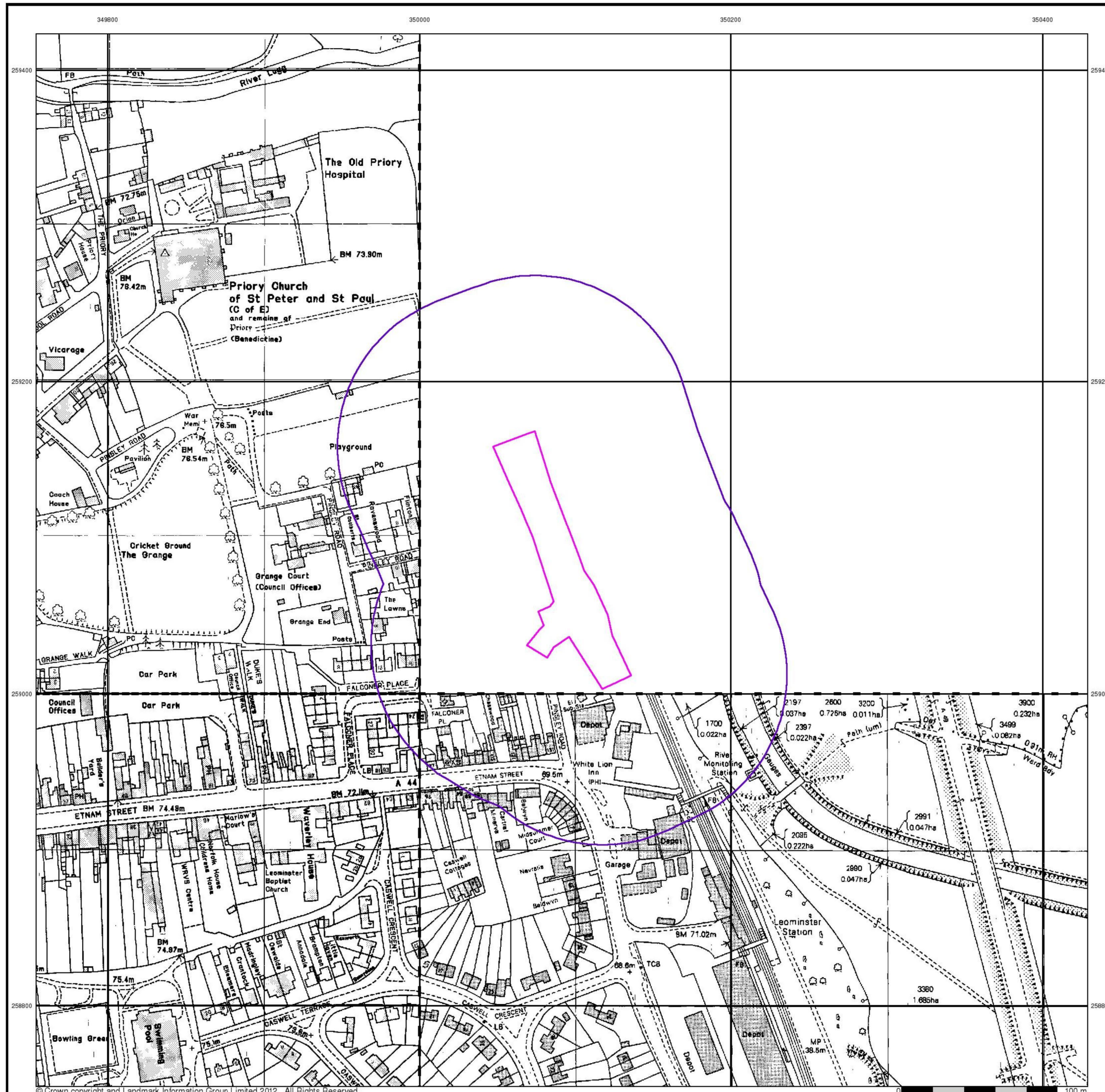

Additional SIMs

Published 1983 - 1989

Source map scale - 1:2,500

The SIM cards (Ordnance Survey's 'Survey of Information on Microfilm') are further, minor editions of mapping which were produced and published in between the main editions as an area was updated. They date from 1947 to 1994, and contain detailed information on buildings, roads and land-use. These maps were produced at both 1:2,500 and 1:1,250 scales.

Map Name(s) and Date(s)

SO4959 1983 1:2,500	SO5059 1989 1:2,500
SO4958 1984 1:2,500	SO5058 1986 1:2,500

Historical Map - Segment A13

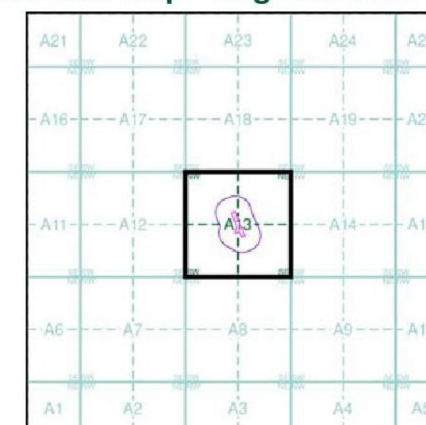

Order Details

Order Number: 41277440_1_1
 Customer Ref: EMS3512
 National Grid Reference: 350090, 259080
 Slice: A
 Site Area (Ha): 0.48
 Search Buffer (m): 100

Site Details

Pinsley Mill, Pinsley Road, Leominster, HR6 8NN



Additional SIMs

Published 1989 - 1993

Source map scale - 1:2,500

The SIM cards (Ordnance Survey's 'Survey of Information on Microfilm') are further, minor editions of mapping which were produced and published in between the main editions as an area was updated. They date from 1947 to 1994, and contain detailed information on buildings, roads and land-use. These maps were produced at both 1:2,500 and 1:1,250 scales.

Map Name(s) and Date(s)

SO4959	1989	1:2,500
SO4958	1993	1:2,500
SO5058	1989	1:2,500

Historical Map - Segment A13

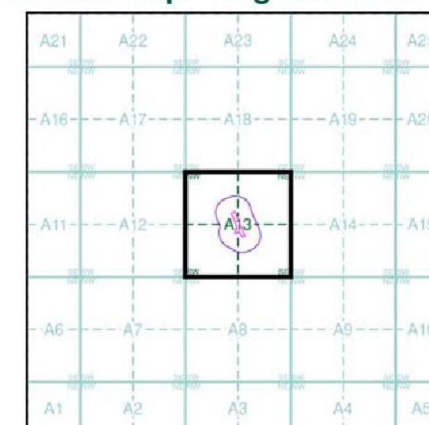

Order Details

Order Number: 41277440_1_1
 Customer Ref: EMS3512
 National Grid Reference: 350090, 259080
 Slice: A
 Site Area (Ha): 0.48
 Search Buffer (m): 100

Site Details

Pinsley Mill, Pinsley Road, Leominster, HR6 8NN



Additional SIMs

Published 1992

Source map scale - 1:2,500

The SIM cards (Ordnance Survey's 'Survey of Information on Microfilm') are further, minor editions of mapping which were produced and published in between the main editions as an area was updated. They date from 1947 to 1994, and contain detailed information on buildings, roads and land-use. These maps were produced at both 1:2,500 and 1:1,250 scales.

Map Name(s) and Date(s)

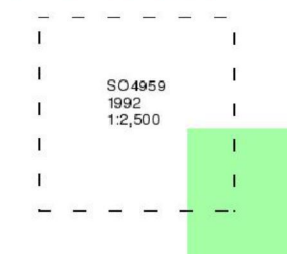

Historical Map - Segment A13

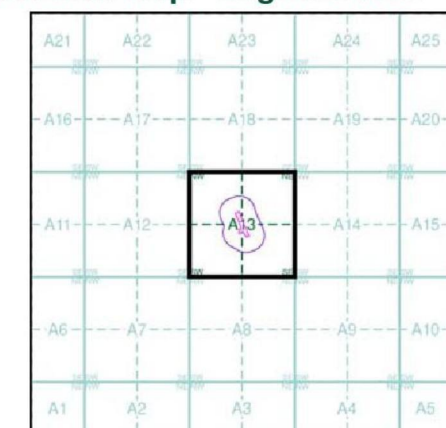

Order Details

Order Number: 41277440_1_1
 Customer Ref: EMS3512
 National Grid Reference: 350090, 259080
 Slice: A
 Site Area (Ha): 0.48
 Search Buffer (m): 100

Site Details

Pinsley Mill, Pinsley Road, Leominster, HR6 8NN

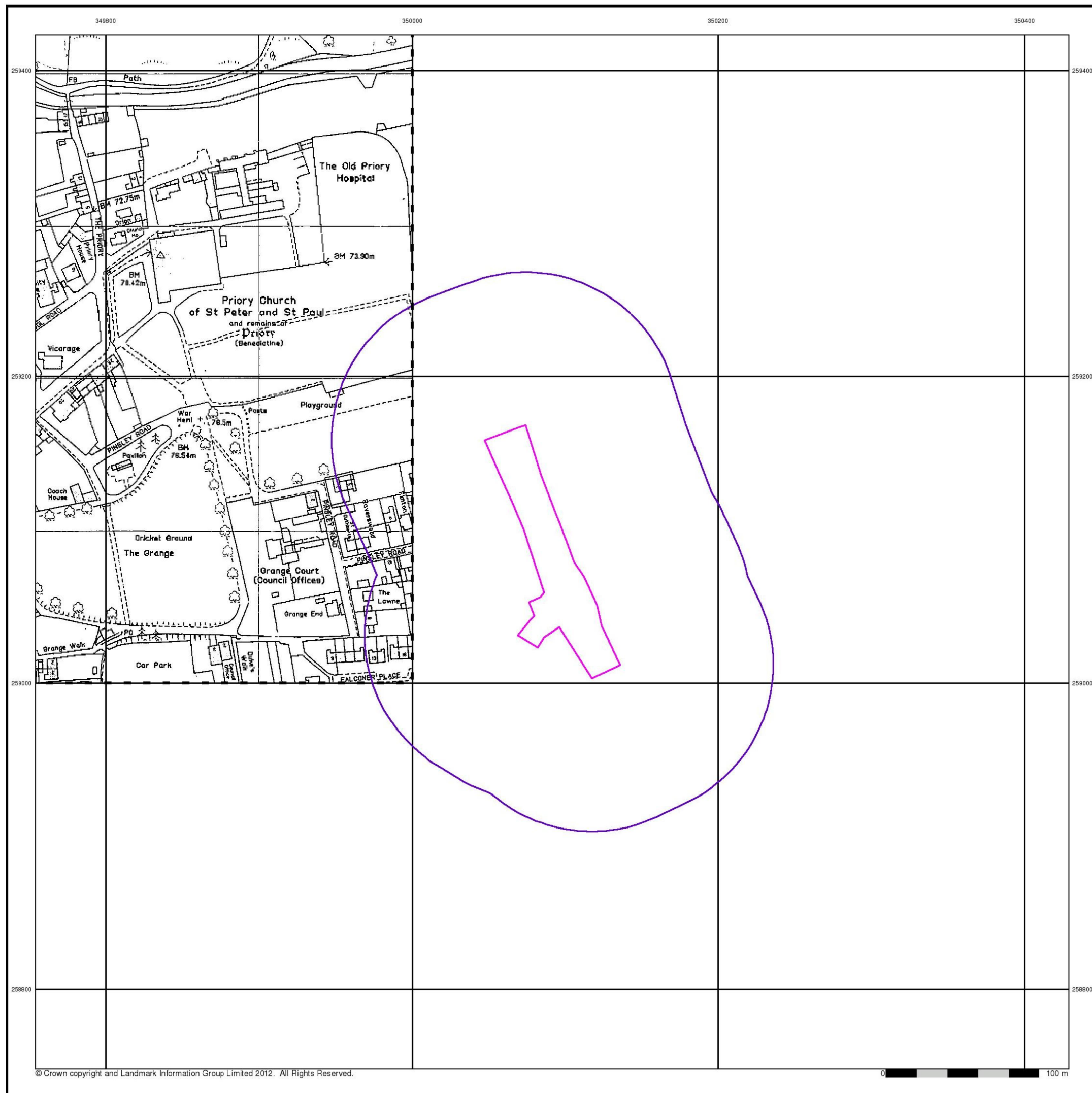

Large-Scale National Grid Data

Published 1995

Source map scale - 1:2,500

'Large Scale National Grid Data' superseded SIM cards (Ordnance Survey's 'Survey of Information on Microfilm') in 1992, and continued to be produced until 1999. These maps were the fore-runners of digital mapping and so provide detailed information on houses and roads, but tend to show less topographic features such as vegetation. These maps were produced at both 1:2,500 and 1:1,250 scales.

Map Name(s) and Date(s)

SO4959	SO5059
1995	1995
1:2,500	1:2,500
SO4958	SO5058
1995	1995
1:2,500	1:2,500

Historical Map - Segment A13

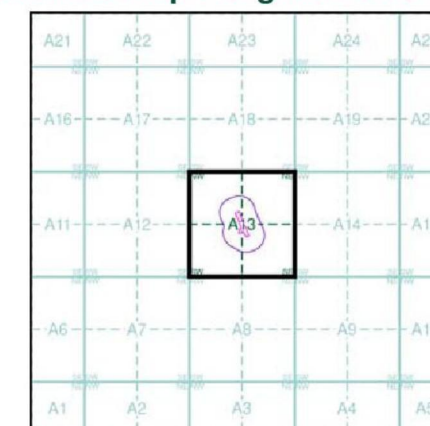

Order Details

Order Number: 41277440_1_1
 Customer Ref: EMS3512
 National Grid Reference: 350090, 259080
 Slice: A
 Site Area (Ha): 0.48
 Search Buffer (m): 100

Site Details

Pinsley Mill, Pinsley Road, Leominster, HR6 8NN



Large-Scale National Grid Data

Published 1995 - 1996

Source map scale - 1:2,500

'Large Scale National Grid Data' superseded SIM cards (Ordnance Survey's 'Survey of Information on Microfilm') in 1992, and continued to be produced until 1999. These maps were the fore-runners of digital mapping and so provide detailed information on houses and roads, but tend to show less topographic features such as vegetation. These maps were produced at both 1:2,500 and 1:1,250 scales.

Map Name(s) and Date(s)

SO4959	1995	1:2,500
SO4958	1995	1:2,500
SO5058	1996	1:2,500

Historical Map - Segment A13

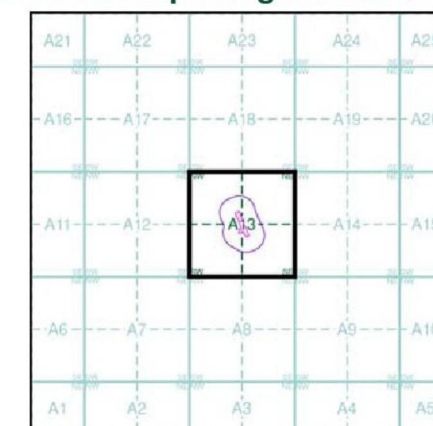

Order Details

Order Number: 41277440_1_1
 Customer Ref: EMS3512
 National Grid Reference: 350090, 259080
 Slice: A
 Site Area (Ha): 0.48
 Search Buffer (m): 100

Site Details

Pinsley Mill, Pinsley Road, Leominster, HR6 8NN



Large-Scale National Grid Data

Published 1996 - 1997

Source map scale - 1:2,500

'Large Scale National Grid Data' superseded SIM cards (Ordnance Survey's 'Survey of Information on Microfilm') in 1992, and continued to be produced until 1999. These maps were the fore-runners of digital mapping and so provide detailed information on houses and roads, but tend to show less topographic features such as vegetation. These maps were produced at both 1:2,500 and 1:1,250 scales.

Map Name(s) and Date(s)

SO4959	1996	1:2,500
SO4958	1997	1:2,500

Historical Map - Segment A13

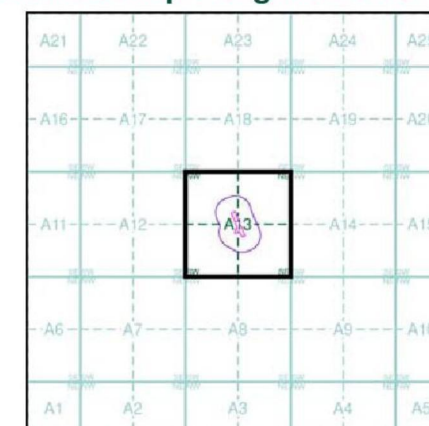

Order Details

Order Number: 41277440_1_1
 Customer Ref: EMS3512
 National Grid Reference: 350090, 259080
 Slice: A
 Site Area (Ha): 0.48
 Search Buffer (m): 100

Site Details

Pinsley Mill, Pinsley Road, Leominster, HR6 8NN

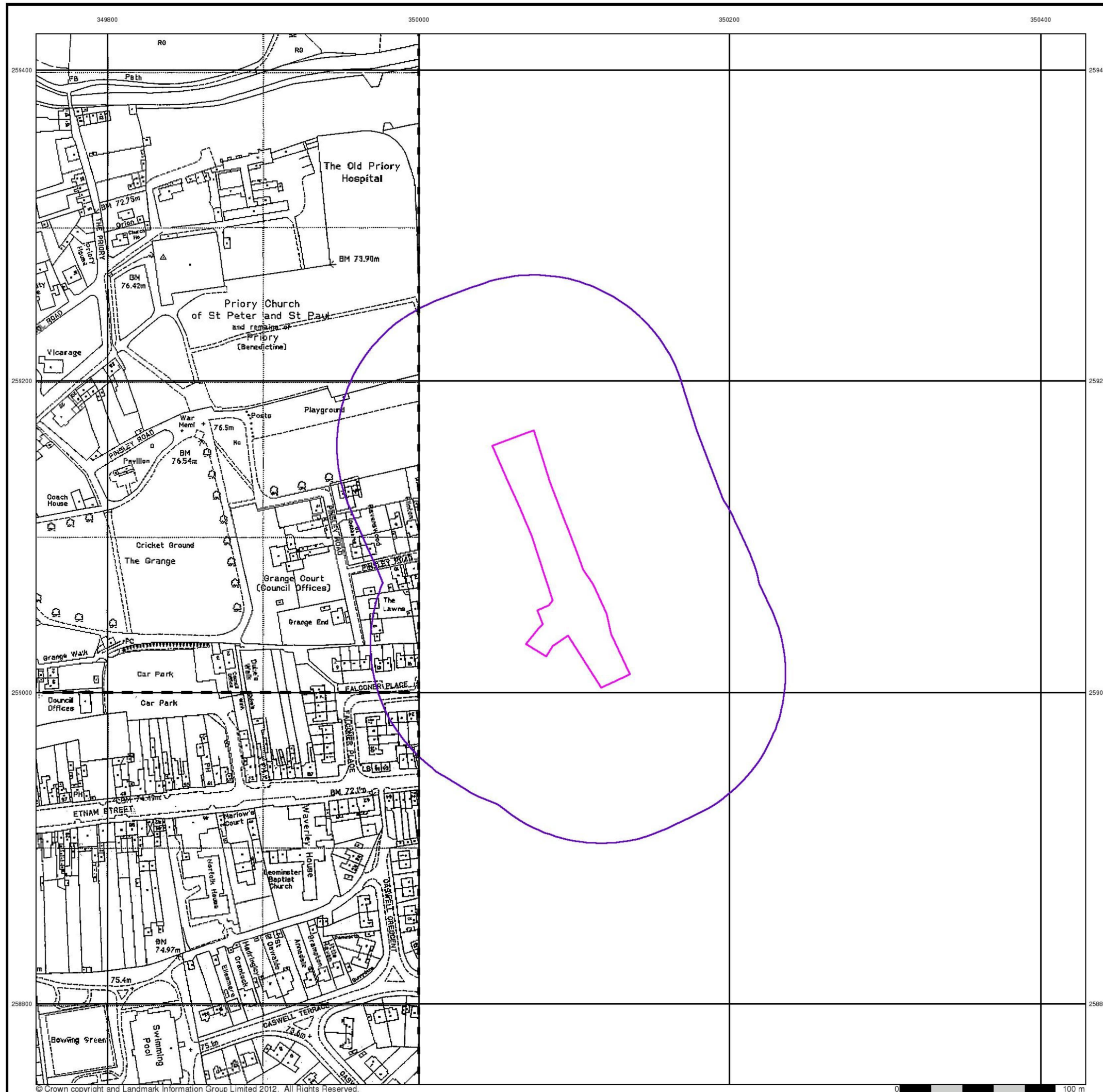

Historical Mapping Legends

Ordnance Survey County Series 1:10,560

	Gravel Pit		Sand Pit		Other Pits
	Quarry		Shingle		Orchard
	Osiers		Reeds		Marsh
	Mixed Wood		Deciduous		Brushwood
	Fir		Furze		Rough Pasture
	Arrow denotes flow of water		Trigonometrical Station		
	Site of Antiquities		Bench Mark		
	Pump, Guide Post, Signal Post		Well, Spring, Boundary Post		
	285 Surface Level				
	Sketched Contour		Instrumental Contour		
	Main Roads		Minor Roads		
	Sunken Road		Raised Road		
	Road over Railway		Railway over River		
	Railway over Road		Level Crossing		
	Road over River or Canal		Road over Stream		
	Road over Stream				
	County Boundary (Geographical)				
	County & Civil Parish Boundary				
	Administrative County & Civil Parish Boundary				
	County Borough Boundary (England)				
	County Burgh Boundary (Scotland)				
	Rural District Boundary				
	Civil Parish Boundary				

Ordnance Survey Plan 1:10,000

	Chalk Pit, Clay Pit or Quarry		Gravel Pit
	Sand Pit		Disused Pit or Quarry
	Refuse or Slag Heap		Lake, Loch or Pond
	Dunes		Boulders
	Coniferous Trees		Non-Coniferous Trees
	Orchard		Scrub
	Bracken		Heath
	Marsh		Reeds
	Building		Glasshouse
	Sloping Masonry		Pylon
	Cutting		Embankment
	Road Under		Road Over
	Level Crossing		Foot Bridge
	Standard Gauge Multiple Track		Standard Gauge Single Track
	Siding, Tramway or Mineral Line		Narrow Gauge
	Geographical County		Administrative County, County Borough or County of City
	Municipal Borough, Urban or Rural District, Burgh or District Council		Borough, Burgh or County Constituency
	Civil Parish		
	BP, BS		Police Station
	Church		Post Office
	Club House		Public Convenience
	Fire Engine Station		Public House
	Foot Bridge		Signal Box
	Fountain		Spring
	Guide Post		Telephone Call Box
	Mile Post		Telephone Call Post
	Mile Stone		Well

1:10,000 Raster Mapping

	Gravel Pit		Refuse tip or slag heap
	Rock		Rock (scattered)
	Boulders		Boulders (scattered)
	Shingle		Mud
	Sand		Sand Pit
	Slopes		Top of cliff
	General detail		Underground detail
	Overhead detail		Narrow gauge railway
	Multi-track railway		Single track railway
	County boundary (England only)		Civil, parish or community boundary
	District, Unitary, Metropolitan, London Borough boundary		Constituency boundary
	Area of wooded vegetation		Non-coniferous trees
	Non-coniferous trees (scattered)		Coniferous trees
	Coniferous trees (scattered)		Positioned tree
	Orchard		Coppice or Osiers
	Rough Grassland		Heath
	Scrub		Marsh, Salt Marsh or Reeds
	Water feature		Flow arrows
	Mean high water (springs)		Mean low water (springs)
	Telephone line (where shown)		Electricity transmission line (with poles)
	Bench mark (where shown)		Triangulation station
	Point feature (e.g. Guide Post or Mile Stone)		Pylon, flare stack or lighting tower
	Site of (antiquity)		Glasshouse
	General Building		Important Building

Historical Mapping & Photography included:

Mapping Type	Scale	Date	Pg
Herefordshire	1:10,560	1885 - 1886	2
Herefordshire	1:10,560	1904 - 1905	3
Herefordshire	1:10,560	1930	4
Herefordshire	1:10,560	1938 - 1953	5
Herefordshire	1:10,560	1953	6
Ordnance Survey Plan	1:10,000	1963 - 1964	7
Ordnance Survey Plan	1:10,000	1974 - 1977	8
Ordnance Survey Plan	1:10,000	1980	9
Ordnance Survey Plan	1:10,000	1990 - 1992	10
10K Raster Mapping	1:10,000	2006	11
10K Raster Mapping	1:10,000	2012	12

Historical Map - Slice A

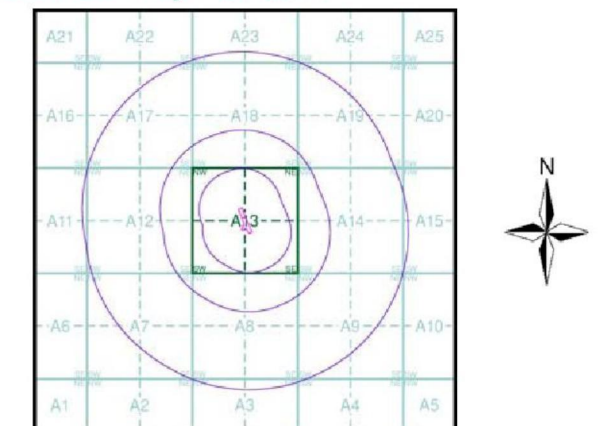

Order Details

Order Number: 41277440_1_1
 Customer Ref: EMS3512
 National Grid Reference: 350090, 259080
 Slice: A
 Site Area (Ha): 0.48
 Search Buffer (m): 1000

Site Details

Pinsley Mill, Pinsley Road, Leominster, HR6 8NN

Herefordshire

Published 1885 - 1886

Source map scale - 1:10,560

The historical maps shown were reproduced from maps predominantly held at the scale adopted for England, Wales and Scotland in the 1840's. In 1854 the 1:2,500 scale was adopted for mapping urban areas; these maps were used to update the 1:10,560 maps. The published date given therefore is often some years later than the surveyed date. Before 1938, all OS maps were based on the Cassini Projection, with independent surveys of a single county or group of counties, giving rise to significant inaccuracies in outlying areas. In the late 1940's, a Provisional Edition was produced, which updated the 1:10,560 mapping from a number of sources. The maps appear unfinished - with all military camps and other strategic sites removed. These maps were initially overprinted with the National Grid. In 1970, the first 1:10,000 maps were produced using the Transverse Mercator Projection. The revision process continued until recently, with new editions appearing every 10 years or so for urban areas.

Map Name(s) and Date(s)

012SE	1886	1:10,560
019NE	1885	1:10,560

Historical Map - Slice A

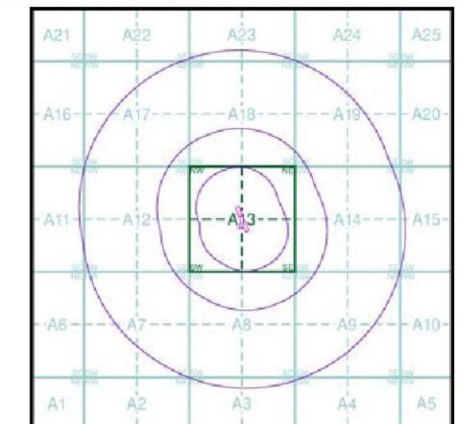

Order Details

Order Number: 41277440_1_1
 Customer Ref: EMS3512
 National Grid Reference: 350090, 259080
 Slice: A
 Site Area (Ha): 0.48
 Search Buffer (m): 1000

Site Details

Pinsley Mill, Pinsley Road, Leominster, HR6 8NN

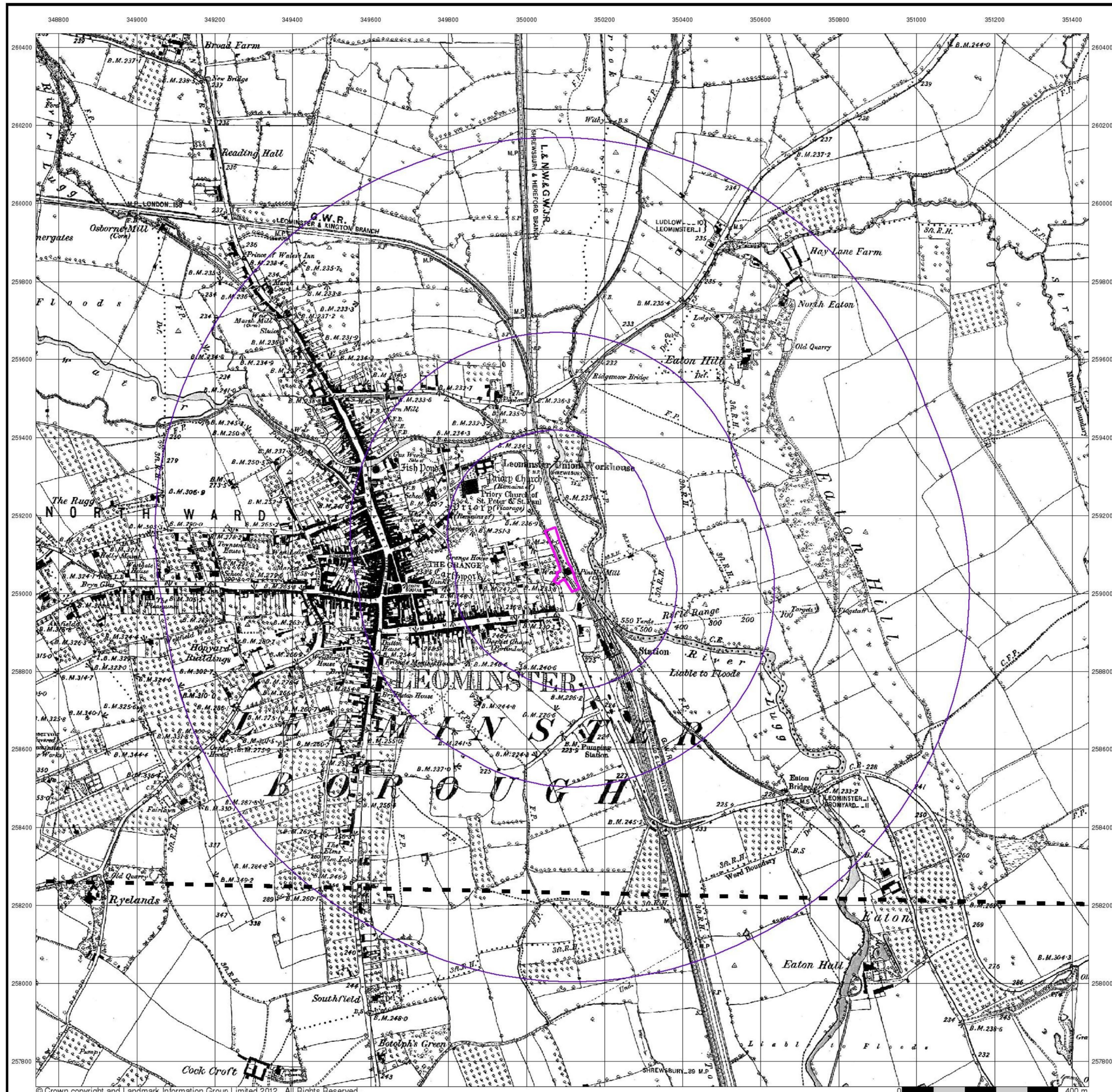

Herefordshire

Published 1904 - 1905

Source map scale - 1:10,560

The historical maps shown were reproduced from maps predominantly held at the scale adopted for England, Wales and Scotland in the 1840's. In 1854 the 1:2,500 scale was adopted for mapping urban areas; these maps were used to update the 1:10,560 maps. The published date given therefore is often some years later than the surveyed date. Before 1938, all OS maps were based on the Cassini Projection, with independent surveys of a single county or group of counties, giving rise to significant inaccuracies in outlying areas. In the late 1940's, a Provisional Edition was produced, which updated the 1:10,560 mapping from a number of sources. The maps appear unfinished - with all military camps and other strategic sites removed. These maps were initially overprinted with the National Grid. In 1970, the first 1:10,000 maps were produced using the Transverse Mercator Projection. The revision process continued until recently, with new editions appearing every 10 years or so for urban areas.

Map Name(s) and Date(s)

012SE	1904	1:10,560
019NE	1905	1:10,560

Historical Map - Slice A

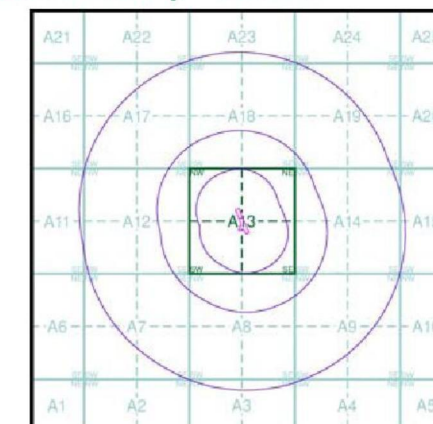

Order Details

Order Number: 41277440_1_1
 Customer Ref: EMS3512
 National Grid Reference: 350090, 259080
 Slice: A
 Site Area (Ha): 0.48
 Search Buffer (m): 1000

Site Details

Pinsley Mill, Pinsley Road, Leominster, HR6 8NN

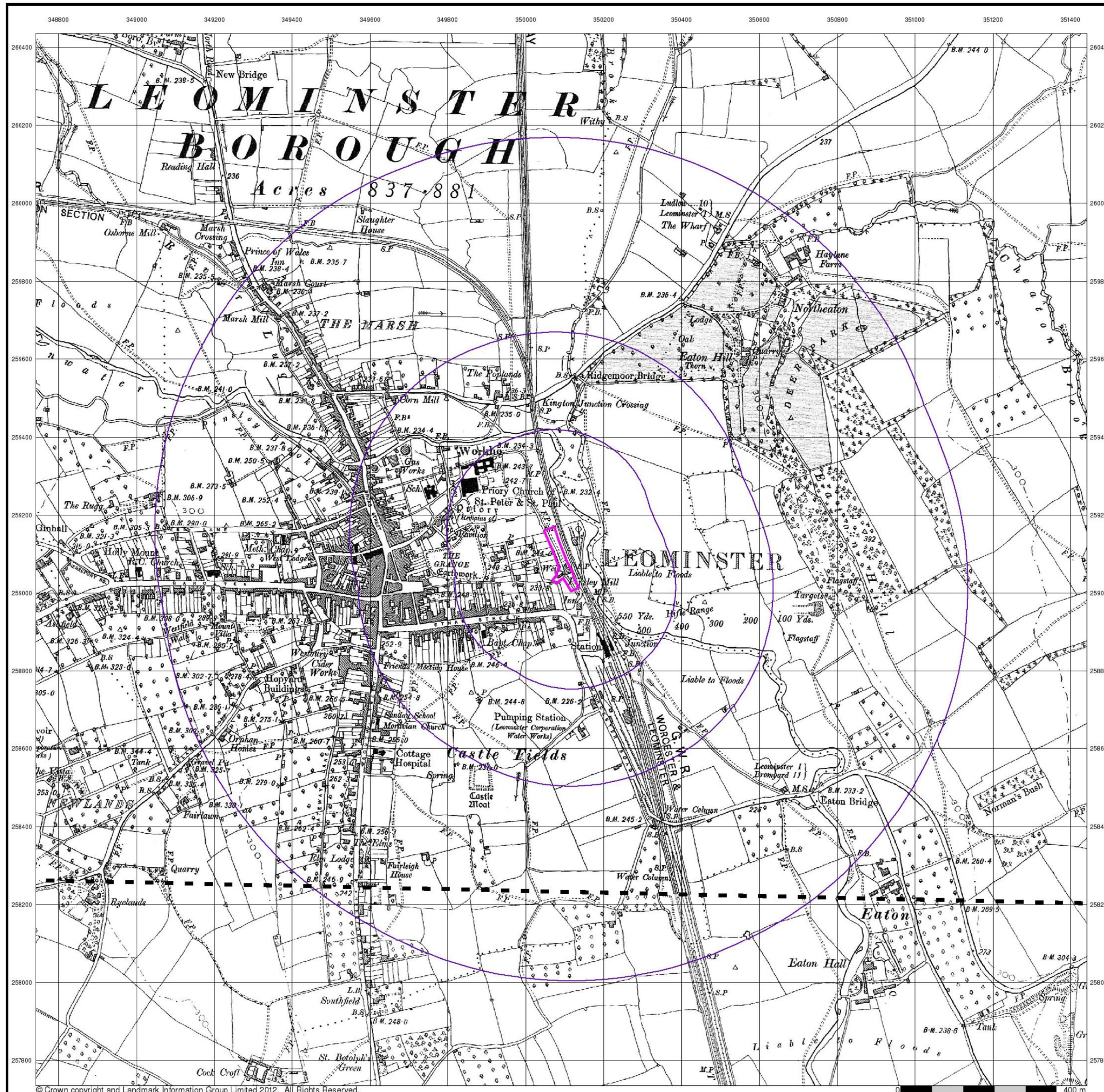

Herefordshire

Published 1930

Source map scale - 1:10,560

The historical maps shown were reproduced from maps predominantly held at the scale adopted for England, Wales and Scotland in the 1840's. In 1854 the 1:2,500 scale was adopted for mapping urban areas; these maps were used to update the 1:10,560 maps. The published date given therefore is often some years later than the surveyed date. Before 1938, all OS maps were based on the Cassini Projection, with independent surveys of a single county or group of counties, giving rise to significant inaccuracies in outlying areas. In the late 1940's, a Provisional Edition was produced, which updated the 1:10,560 mapping from a number of sources. The maps appear unfinished - with all military camps and other strategic sites removed. These maps were initially overprinted with the National Grid. In 1970, the first 1:10,000 maps were produced using the Transverse Mercator Projection. The revision process continued until recently, with new editions appearing every 10 years or so for urban areas.

Map Name(s) and Date(s)

012SE
1930
1:10,560
019NE
1930
1:10,560

Historical Map - Slice A

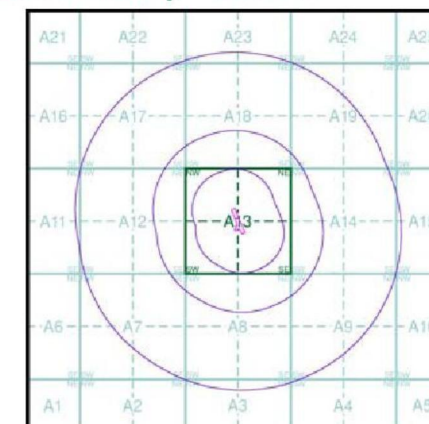

Order Details

Order Number: 41277440_1_1
 Customer Ref: EMS3512
 National Grid Reference: 350090, 259080
 Slice: A
 Site Area (Ha): 0.48
 Search Buffer (m): 1000

Site Details

Pinsley Mill, Pinsley Road, Leominster, HR6 8NN



