

Notes

- Datum : Ordnance Survey Benchmark (OSBM) on Dockhill Well Farm, value 129.842m A.O.D.
- Survey Grid : Local Arbitrary
- Survey contents correct as of date of survey and survey undertaken to agreed specification
- All critical dimensions to be checked prior to site works
- All floor coverings are carpet unless stated otherwise

Legend of Abbreviations

- B Beam underside height
- C Internal call height from the floor
- CL Cover level
- CS Ceiling slope height from the floor
- F/C Fake ceiling
- FFL Finished floor level
- G Gully
- H Internal head height from the floor
- IC Inspection cover
- IL Invert level
- MH Manhole
- P Purlin underside height
- R Ridge underside height
- RWP Rainwater pipe
- SLB Sloping beam
- SP Soil vent pipe
- SVP Soil vent pipe
- U/S Underside height
- +10.00 Floor level
- (2.50) Floor to ceiling height
- Boxing
- Hatching indicates extent of structure
- Overhead feature, eg. beam, ceiling slope, opening
- Direction of floorboards or joists
- Up for stairs
- Down for ceiling slopes

A D Horner Limited

Land and Measured Building Surveyors

51 Bridge Street
Pershore
Worcestershire
WR10 1AL

1 Folly House
Venton
Plymouth, Devon
PL7 5DS

Telephone: 01386-555486 Telephone: 01752-837382

Fax: 01386-555247

Website: www.adhorner.co.uk
E-mail: enquiries@adhorner.co.uk

Title The Furlongs, Brockhampton, Herefordshire HR1 4SA - First Floor Plan	
Client Ms D Hill	
Date January 2016	Drawing No. 4575-15JAN16-03
Plot scale 1 : 50 on A2 Sheet Digital scale 1 CAD unit : 1 metre	Revision
Surveyed MJM	Checked JKW
Approximate Ordnance Survey Grid North	
© A.D.Horner Limited 2016	

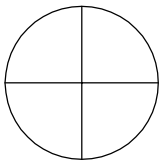
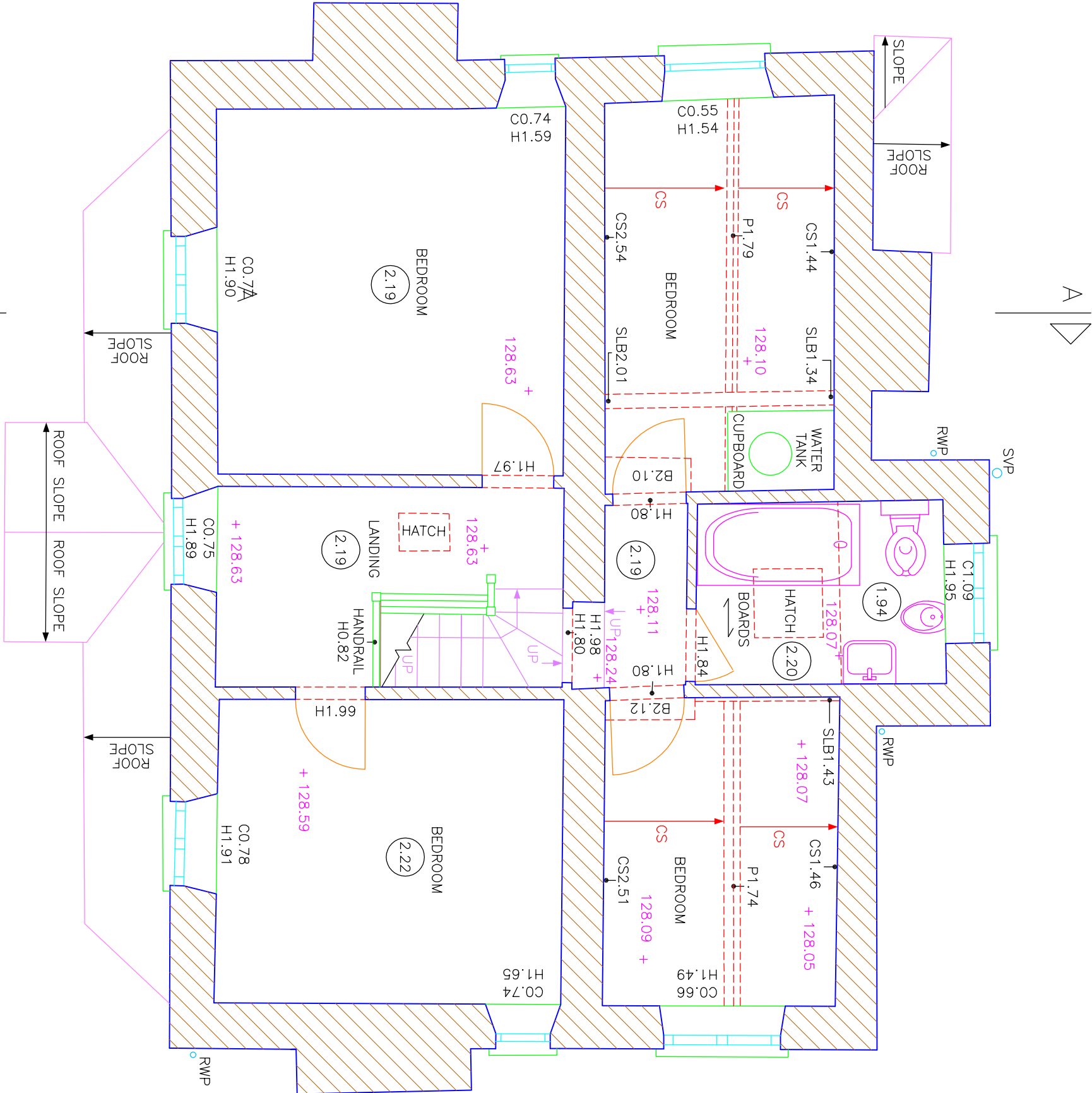

COMMON REFERENCE
POINT