

- Linhay Barn Key:**
- A - All stonework repaired using lime mortar to match existing.
  - B - New stonework to match existing.
  - C - New timber frame window with powder coated finish in existing opening.
  - D - New timber frame door with powder coated finish in existing opening.
  - E - Corrugated metal cladding to match existing.
  - F - Corrugated metal roofing colour TBC
  - G - Existing opening to be glazed and lintel repaired to match existing.
  - H - All rainwater goods in aluminium PPC, colour TBC
  - I - Louvred horizontal timber cladding to existing opening.
  - J - New Timber structural column.
  - K - Horizontal timber clad double doors
  - L - New metal fascia to match existing.
  - M - Existing opening, lintel retained.
  - N - Existing wall structure reclad with corrugated metal to match existing.
  - O - New corrugated metal clad doors to refuse store.
  - P - Existing roof structure reclad with corrugated metal to match existing.
  - Q - Minor repairs to existing roof where necessary.
  - R - ASHP
  - S - Timber column and joist structure retained and repaired where necessary.
  - T - Drainage gully in floor with appropriate trap



Notes

DESIGNERS HAZARD IDENTIFICATION:

Site Key:

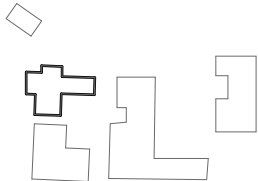

Rev	Date	Description	DRW	CHK
Project				
Penymoor Farm				
Project No. 1037				
Date		Status		
18/Mar/24		PLANNING		
Scale		Drawn	Checked	
1:100 at A3		MG	MH	
Drawing				
Proposed Ground Floor Plan - Linhay				
Drawing No. PL320			Rev.	