

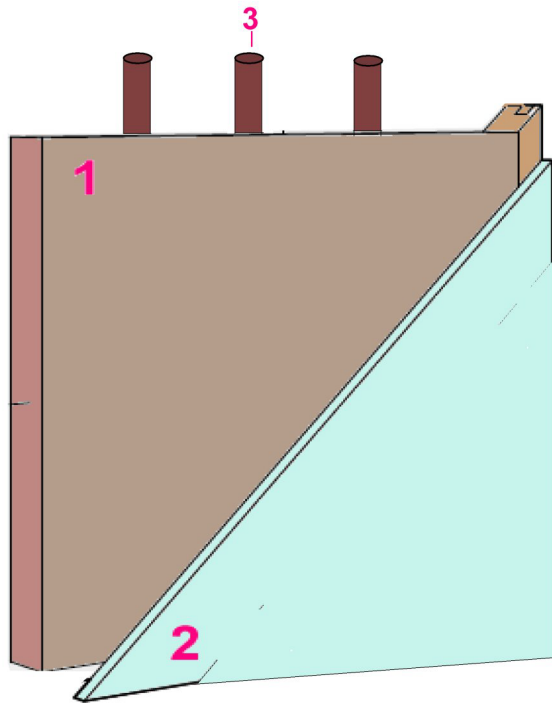

Example image: Showing hazel stakes, and shuttering during the infill process - and right - Finished panel



Infill Panels Repair



Hempcrete: Hemp Shiv + Hydraulic Lime Binder + Pozzolans

Hempcrete is a vapour permeable material, the hemp shiv is a hard cellulose material very similar to timber, and so it controls moisture on a similar rate to existing wooden elements, preventing a build-up of moisture against vulnerable historic buildings. The embodied carbon credentials of hempcrete are excellent. It is carbon negative, as for every cubic metre of hempcrete installed into a building at least 110 kg of carbon are locked up for the lifetime of the building. The material is non-toxic and forms an ideal substrate for lime renders.

Existing Thermalite Block panels will be removed, and hazel stake uprights will be added to the inside of the panel frame - The panel will then be shuttered 1/3 of panel height and in-filled with Hempcrete. Panel will then be shuttered 2/3 and in-filled further until last 1/3 of panel is completed. When cured, the Hempcrete panel is covered with a lime render.

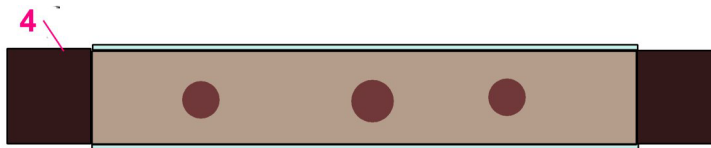

- 1 - Hempcrete
- 2 - Lime Render
- 3 - Hazel Panel Stakes
- 4 - Existing Oak Frame