

**FLAT ROOF CONSTRUCTION/INSULATION** (to achieve a min.0.13 W/m<sup>2</sup>.K 'U' value)  
High performance single ply roofing membrane laid to manufacturers recommendations over Flat roof insulation as 'Kingspan ThermaRoof TR27' to achieve 0.13 'U' value minimum. 90mm outer layer on 85mm inner layer as per manufacturers instructions bonded to Vapour control Layer of 1000guage polythene DPM laid over 22mm wpb exterior grade plywood EN 636-3 S (Structural) over structural deck. Timber Firing pieces laid to 1:80 fall over Structural flat roof deck as detailed by Structural Engineer. 2 layers of 12.5mm plasterboard and skim finish internally.

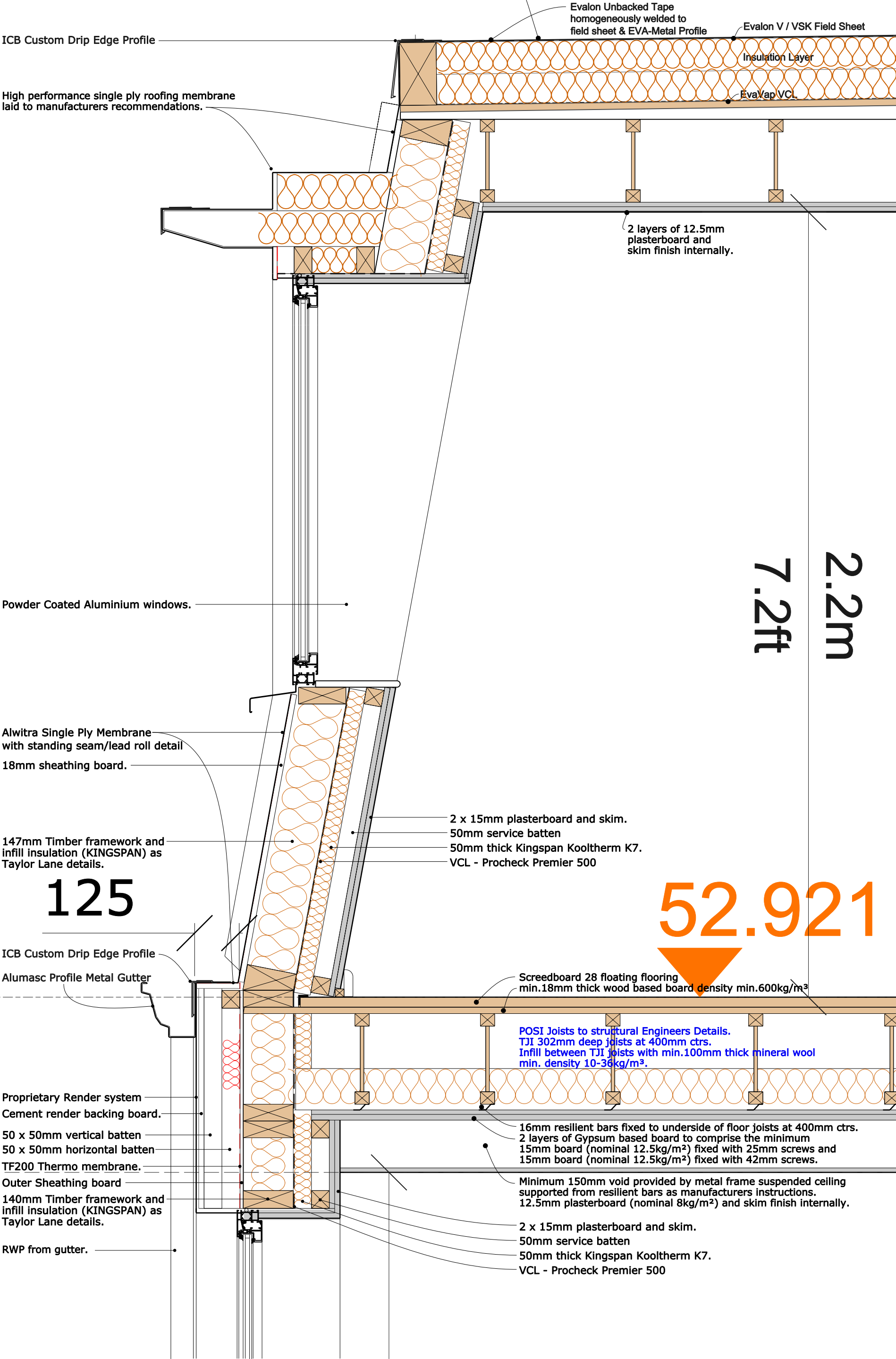

DATE

JAN 18

DRAWN BY

CE

SCALE @ A3

1:10

CHECKED BY

PG

DO NOT SCALE FROM THIS DRAWING

SCALE: 1:10

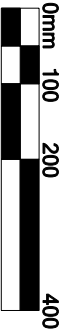

DRAWING NO.

7051-1-66B

REVISIONS

B - 21-09-18 - Mansard detail revised - CE

EAST STREET EAVES DETAIL

ALBAN HOUSE (HEREFORD) LTD  
16-18 HIGH TOWN, HEREFORD