

Generic Notes

1. CONTRACTOR TO CHECK ALL DIMENSIONS ON SITE PRIOR TO COMMENCEMENT OF WORKS. ANY DISCREPANCIES TO BE BROUGHT TO THE ATTENTION OF THE ARCHITECT.
2. DO NOT SCALE FROM THIS DRAWING. USE ONLY DIMENSIONS SHOWN ON DRAWINGS. DIMENSIONS FIGURED ARE TO THE NEAREST 5MM.

Project Notes

1. THIS DRAWING WAS PREPARED USING SURVEY INFORMATION PROVIDED BY THE CLIENT.
2. TO BE READ WITH ALL RELEVANT DRAWINGS AND SPECIFICATIONS.
3. THIS DRAWING IS SUBJECT TO STATUTORY APPROVALS. CONTRACTOR TO SUBMIT DRAWINGS FOR BUILDING CONTROL INSPECTORS COMMENT / APPROVAL.
4. THIS DRAWING WAS PREPARED FOR PLANNING PURPOSE ONLY AND IS NOT A CONSTRUCTION ISSUE
5. ALL DEMOLITION AND EXCAVATION WORKS SUBJECT TO STRUCTURAL ENGINEERS APPROVAL AND FULL DESIGN AND SPECIFICATION.

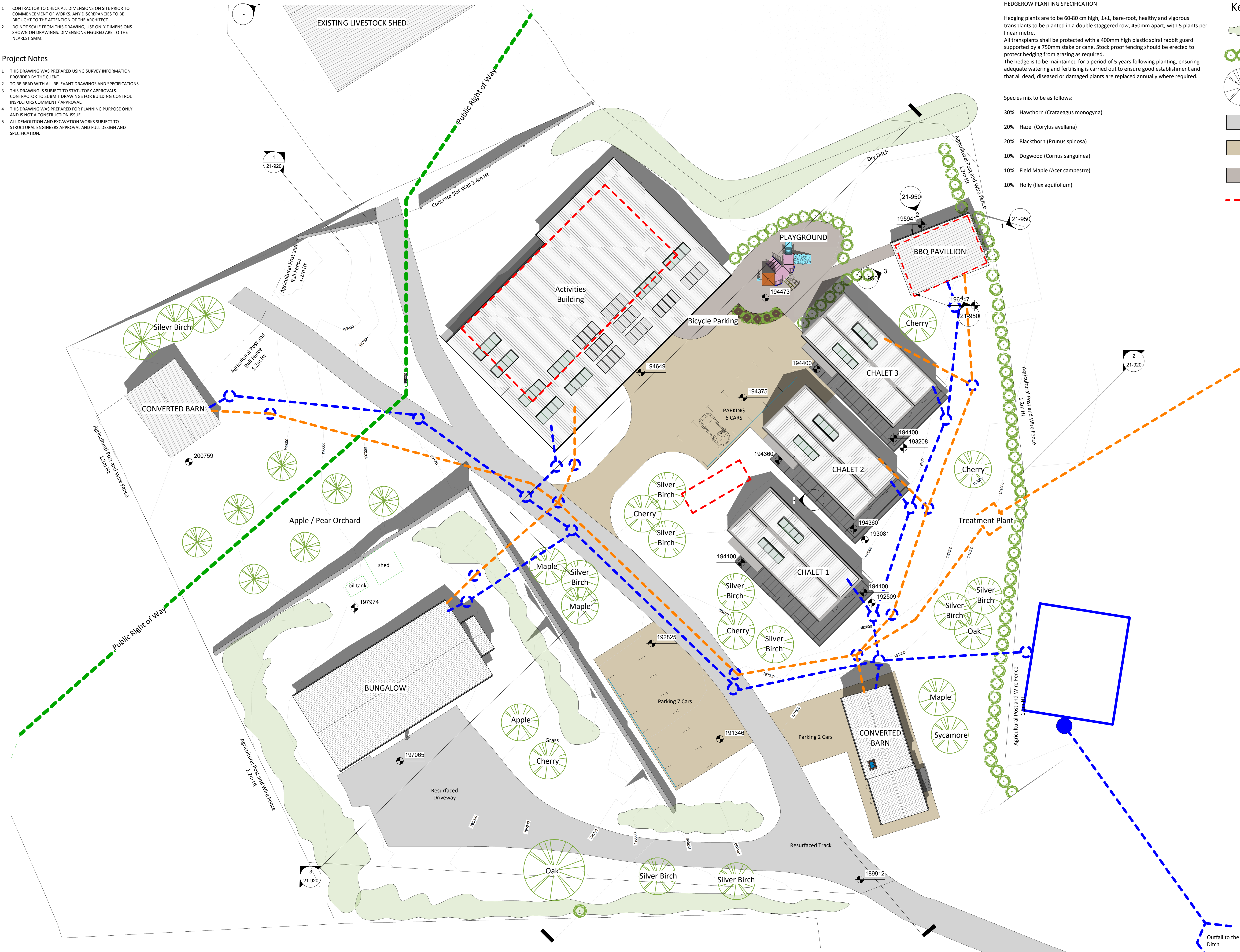

HEDGEROW PLANTING SPECIFICATION

Hedging plants are to be 60-80 cm high, 1+1, bare-root, healthy and vigorous transplants to be planted in a double staggered row, 450mm apart, with 5 plants per linear metre.

All transplants shall be protected with a 400mm high plastic spiral rabbit guard supported by a 750mm stake or cane. Stock proof fencing should be erected to protect hedging from grazing as required.

The hedge is to be maintained for a period of 5 years following planting, ensuring adequate watering and fertilising is carried out to ensure good establishment and that all dead, diseased or damaged plants are replaced annually where required.

Species mix to be as follows:

- 30% Hawthorn (Crataegus monogyna)
- 20% Hazel (Corylus avellana)
- 20% Blackthorn (Prunus spinosa)
- 10% Dogwood (Cornus sanguinea)
- 10% Field Maple (Acer campestre)
- 10% Holly (Ilex aquifolium)

Key:

- Existing Hedge and Trees
- New Hedge
- Specimen Tree Planting
- Crushed stone permeable track
- Pearmeable paving
- Woodchip floor finish
- Buildings / structures to be demolished, removed from site.

Drainage

- Hydro-Brake
- Manhole
- Plot Drainage
- SuDS
- Foul Drainage

For full details of drainage details please refer to Drainage Strategy produced by Hydro-logic Services Ref: L0319

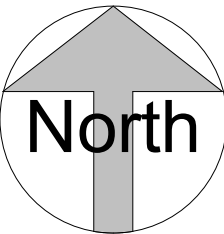

2 0 2 4 6 8 10
SCALE 1:200
m

Rev	Description	Date
A	Drainage Details Added	15.05.2021
B	Public Right of Way added	30.06.2021
C	Demolished buildings line added	24.08.2021
D	Tree and Hedge planting details added	15.10.2021

Drawing Status
Project Status

Client:
MR SHEPPARD

Project:
CAERWENDY, ST WEONARDS

Drawing Title:
PROPOSED SITE PLAN

Project Number: 3167

Date: 19.03.2021

Scale at A1: 1 : 200

Drawing Number: Revision:

21-900 D

OWENTOMS
ARCHITECTS
ARCHITECTURE & DESIGN

Contact:
M: 07811946172
E: enquiries@owentomsarchitect.com

Proposed Site Plan
1 : 200